

STONE



2/45 Howard Avenue Dee Why, NSW



Refreshed beachside pad of utmost convenience

Quietly tucked away from the street within a well-maintained block of just 11 residences, this smart apartment presents a seaside lifestyle of exceptional ease. Enjoying a convenient ground-floor position and east aspect, it boasts tasteful interior updates and a fantastic location on the doorstep to shops, B-Line city buses, restaurants and Dee Why Beach.

Price:

Price Guide \$590,000-\$620,000



Louise Ashdown

0414 764 108



Chris Elliott

0410 416 066



(NOT IN POSITION)
EXTERNAL LAUNDRY NOT SHOWN

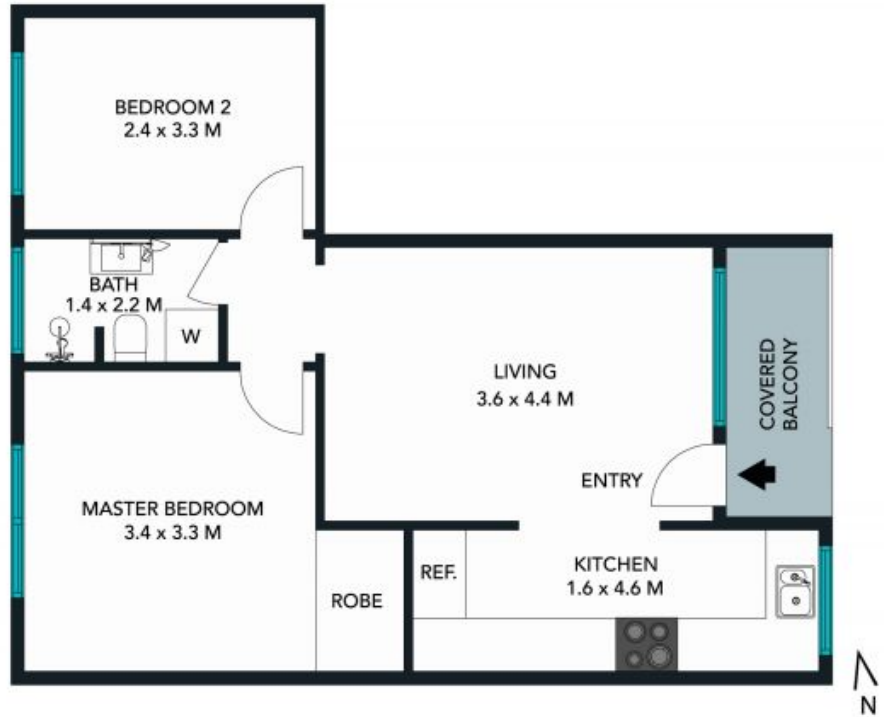

The floor plan is not to scale; measurements are indicative and in metres. Exterior elements are not in position. Plans should not be relied on. Interested parties should make and rely on their own enquiries.

2/45 Howard Avenue, Dee Why
stonerealestate.com.au

Produced by DIAKRIT



The floor plan is not to scale; measurements are indicative and in metres. All features included in this 3D plan are for inspiration purposes only. This is not an exact replica of the property or the position of exterior elements. Plans should not be relied on. Interested parties should make and rely on their own enquiries.

2/45 Howard Avenue, Dee Why
stonerealestate.com.au

Produced by DIAKRIT