



11 Adelaide Street Balgowlah Heights, NSW 4 2 2

P&O classic on premium land with panoramic views

Awe-inspiring 180 degree views from the ocean and harbour to Balmoral Beach and the city skyline provide a breathtaking backdrop to this beautiful preserved character home. Placed on 518sqm of gently sloping land in one of the peninsula's most exclusive and desirable cul-de-sacs, it presents an opportunity to reconfigure and fully capitalise on its premier setting (STCA).

Price:

Contact Agent



Eddy Piddington

0414 333 907

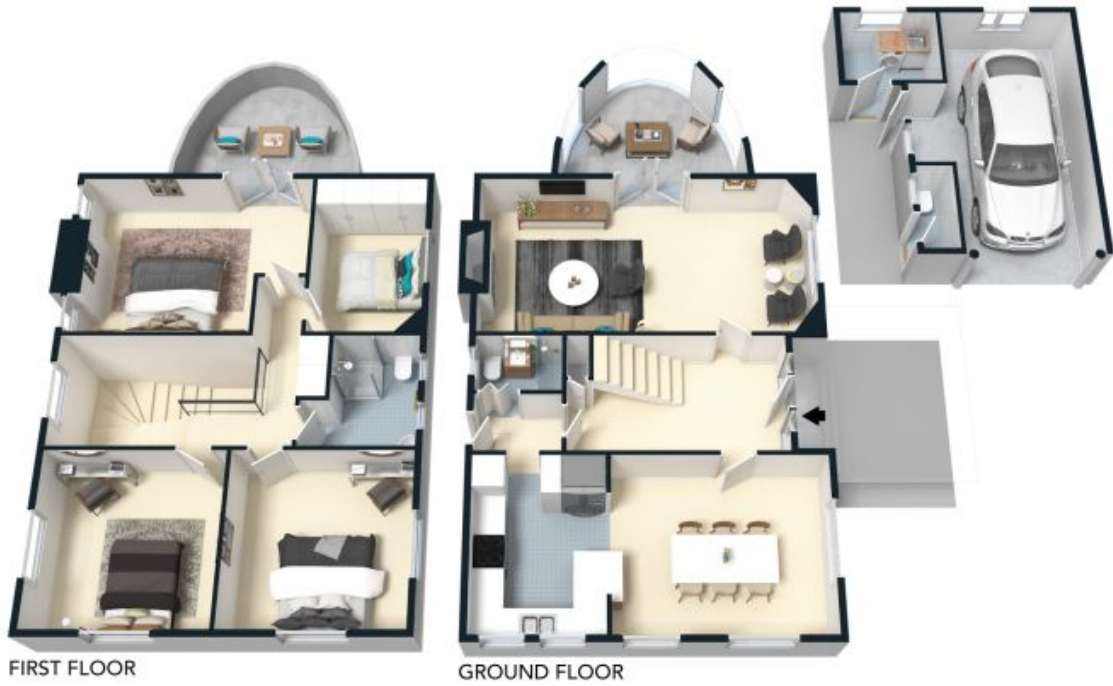

FIRST FLOOR

GROUND FLOOR



The floor plan is not to scale; measurements are indicative and in metres. All features included in this 3D plan are for inspiration purposes only. This is not an exact replica of the property or the position of exterior elements. Plans should not be relied on. Interested parties should make and rely on their own enquiries.

11 Adelaide Street, Balgowlah Heights
stonerealestate.com.au

Produced by DIAKRIT



The site plan and floor plan are not to scale; measurements are indicative and in metres. Bushes and trees are placed for illustration purposes. Plans should not be relied on. Interested parties should make and rely on their own enquiries.

11 Adelaide Street, Balgowlah Heights
 stonerealestate.com.au

Produced by DIAKRIT