



54 Margaret Street Petersham, NSW

3 

1 

Impressive space, character and quality

A creative update has produced a fresh modern residence from the classic character of this Federation brick home. Focusing on optimising space, natural light and easy outdoor entertaining, it provides a smart single-storey haven in a central inner west address. Buyers looking for a low-maintenance space that blends a fresh contemporary style with original charm will be immediately attracted to this immaculate property, as well as its highly convenient position.

- An easy stroll to Stanmore trains, cafes, parks and bus transport
- Bright interiors feature high ornate ceilings and timber flooring
- A generous open layout with a lounge room and separate dining area
- Private alfresco BBQ deck and north facing garden at the rear
- Quality gas kitchen, modern bathroom and a separate internal laundry
- Three double bedrooms, a study nook plus a large attic storage space
- Air-conditioning, original fireplace and a storage shed at the rear
- Within minutes to Leichhardt and Annandale's cafe and dining scene

Price:

Contact Agent



Frederico Fraga-Matos

0450 100 100



Joseph Tropiano

0401 002 211

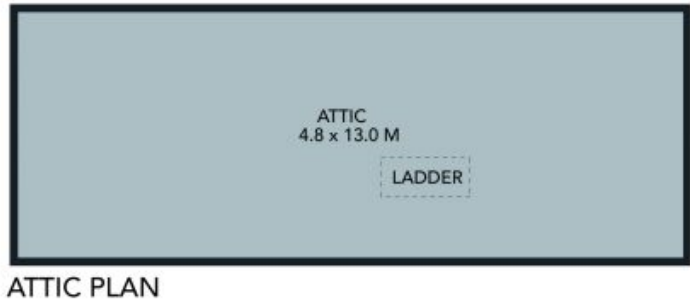

The site plan and floor plan are not to scale; measurements are indicative and in metres. Bushes and trees are placed for illustration purposes. Plans should not be relied on. Interested parties should make and rely on their own enquiries.



ATTIC PLAN

FLOOR PLAN



The floor plan is not to scale; measurements are indicative and in metres. All features included in this 3D plan are for inspiration purposes only. This is not an exact replica of the property or the position of exterior elements. Plans should not be relied on. Interested parties should make and rely on their own enquiries.

54 Margaret Street, Petersham
stonerealestate.com.au

Produced by DIAKRIT