



1/91-95 Campbell Street Woonona, NSW 3 2 2

Perfectly positioned between the beach and village

Presenting as-new, this spectacular recently refurbished townhouse shares only one common wall and is designed with idyllic indoor/outdoor flow to a prime north facing courtyard basking in all day sunlight. Perfectly placed for enviable lifestyle convenience, it's a mere 300 metres to Woonona Village shops and cafes, 500 metres to the beach and moments to schools and transport.

Price: \$720,000



Neil Webster

0439 028 748



Angela Bolton

0437 220 021

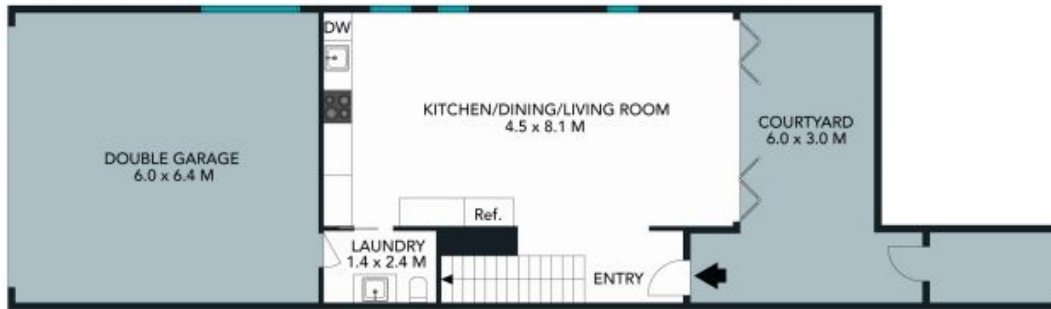

GROUND FLOOR



FIRST FLOOR

The floor plan is not to scale; measurements are indicative and in metres. Exterior elements are not in position. Plans should not be relied on. Interested parties should make and rely on their own enquiries.





GROUND FLOOR



FIRST FLOOR

The floor plan is not to scale; measurements are indicative and in metres. All features included in this 3D plan are for inspiration purposes only. This is not an exact replica of the property or the position of exterior elements. Plans should not be relied on. Interested parties should make and rely on their own enquiries.



1/91-95 Campbell Street, Woonona
stonerealestate.com.au

Produced by DIAKRIT