



43 Florida Road Palm Beach, NSW



## Beachside Sanctuary

Majestically elevated amid a breathtaking oasis of tropical greenery, this architectural masterpiece basks in views across Palm Beach to the Barrenjoey Head Lighthouse beyond. Filtered in northern light, it embraces unrivalled privacy from an exclusive address, only 250 metres (approx.) from the surf and sand. Beautiful rainforest gardens with colourful native birds. Choice of inclinator or landscaped steps to the main entry which showcases an array of ultra-contemporary and versatile living spaces that transition to wraparound terraces, promoting flexible relaxation and alfresco entertaining all year round.

All bedrooms are peacefully segregated to cater for a larger family or staying guests, while an ensuite connects to each one for convenience. This property is a supremely rare retreat, further appealing with a rainforest sanctuary and private garden secretly situated at the rear.

**Price:** SOLD  
**Council Rates:** \$822.00 p/q  
**Water Rates:** \$172.00 p/q



**Ben McNamara**

0415 587 210



**Sasha de Bilde**

0415 431 254

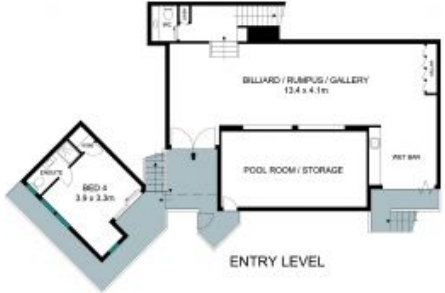

Scale in metres, indicative only. All information contained herein is obtained from sources we believe to be accurate. We cannot guarantee its accuracy. Interested persons should make and rely on their own enquiries.

43 Florida Road, Palm Beach

