



11/20 Benelong Street Seaforth, NSW

3 2 1

Perfect family living

Under instructions from NSW Trustee and Guardian.

Peacefully set in a row of townhouses this house-like residence offers ideal indoor and outdoor living, with the focal point a private alfresco courtyard awash with sunshine. The generous open plan living and dining offers perfect family comfort. The gas kitchen is the working hub enjoying stainless steel appliances, and adjoining family room or casual dining. The roomy split-level layout offers low-maintenance living, minutes to Stockland Balgowlah, city buses and Harbour-front reserves.

- Entertainers' paved courtyard
- Combined lounge and dining opens to grassed front yard
- Gas kitchen with ample storage and bench preparation space
- Three generous bedrooms with b/in robes
- Master bedroom with ensuite, air-conditioning, b/in robes, and private balcony
- Downstairs powder room, separate under stairs storage
- Large garage with ample storage options and versatile access

Price: \$1,450,000
Council Rates: \$320.00 p/q
Water Rates: \$180.00 p/q
Strata Rates: \$950.00 p/q



Andrew White

0406 753 362



Melissah White

0423 025 050



Entry Level

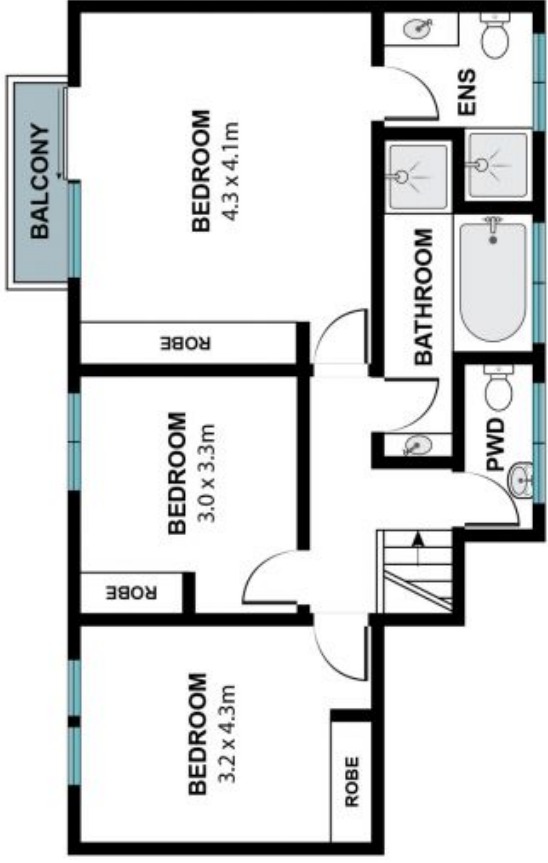

Upper Level

