

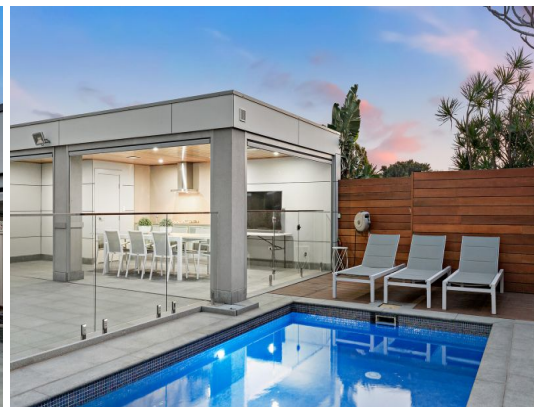

re-ve



11 Nelson Street Sans Souci, NSW

5

3

8

### The Epitome of Family Luxury with Style & Views

A statement piece of inspired design, this visionary home delivers state-of-the-art style at its ultra-contemporary best whilst enjoying elevated water views. The superb family residence has been cleverly crafted for a premium living experience and features a substantial three-level floorplan adorned with luxury appointments, many 'wow-factors' and spaces for all types of entertaining. This fine property promises to provide space, style and an intimately private environment that embraces easycare indoor/outdoor living.

Price:

Guide \$2,800,000



Ray Fadel

0413 177 739





BASEMENT



GROUND FLOOR



FIRST FLOOR

The floor plan is not to scale; measurements are indicative and in metres. All features included in this 3D plan are for inspiration purposes only. This is not an exact replica of the property or the position of exterior elements. Plans should not be relied on. Interested parties should make and rely on their own enquiries.

11 Nelson Street, Sans Souci



STONE