



216/12-14 Queen Street Glebe, NSW



Loft-style retreat with light, style and convenience

This unique top floor apartment features a sleek loft-style floorplan with a clever design that takes full advantage of the space and natural light. Highly private and very secure, it makes an ideal choice for home buyers or investors seeking a smart low maintenance property in a fantastic city-edge lifestyle location. It is set within a boutique warehouse conversion and is within a stroll to Glebe's local cafes, Broadway shopping and even the heart of the CBD.

Price:

Contact Agent



Adrian Vassallo

0406 484 994



Andrew Kanawaty

0450 544 613

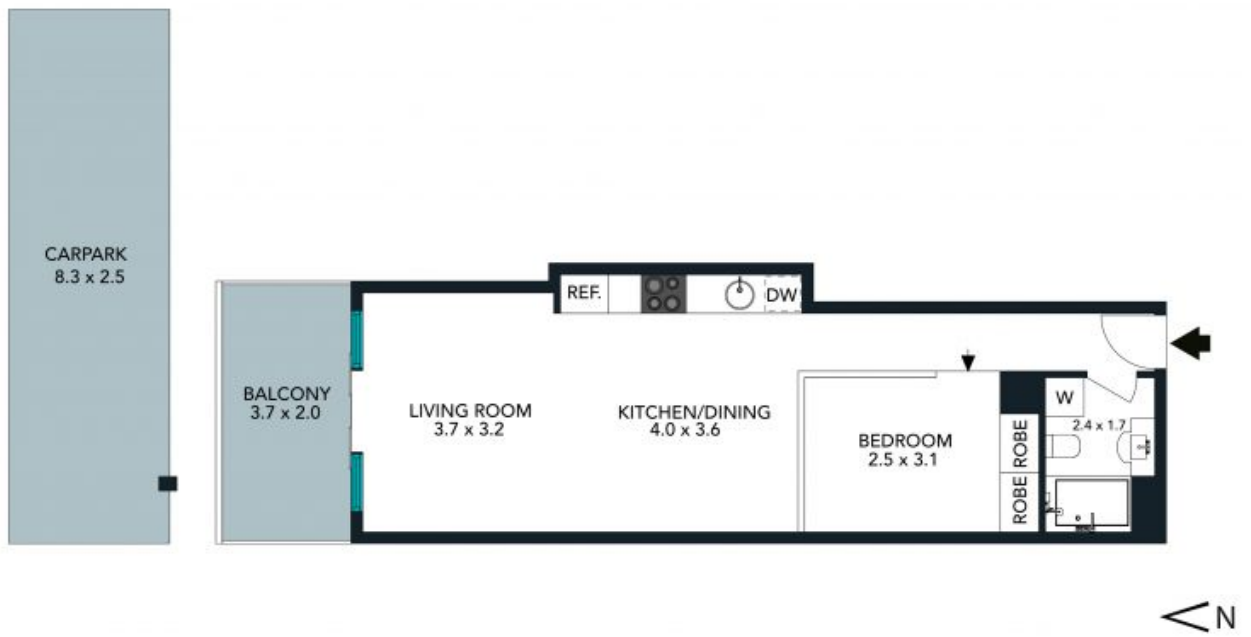

The floor plan is not to scale, measurements are indicative and in metres. Colour elements are not to position. Plans should not be relied on. Interested parties should make and rely on their own enquiries. All other information provided has been collected from reliable sources but cannot be guaranteed for accuracy.

216/12-14 Queen Street, Glebe





The floor plan is not to scale, measurements are indicative and in metres. All features included in this 3D plan are for inspiration purposes only. This is not an exact replica of the property or the position of exterior elements. Plans should not be relied on. Interested parties should make and rely on their own enquiries.

216/12-14 Queen Street, Glebe

