



21 Cromwell Street Croydon, NSW

2 

1 

Charming and spacious semi

Situated in a whisper quiet location and on Croydon/Ashfield border is this charming single level semi-detached residence offering two great sized bedrooms and light-filled interiors. Retaining a blend of period features and modern updates this home offers an outstanding opportunity of a well-proportioned home with separate living and dining areas, undercover entertaining and large easy to maintain rear garden, perfect for entertaining.

Price:

Contact Agent



Frederico Fraga-Matos

0450 100 100



Giorgio Koula

0417 224 341



SITE PLAN

BBQ



(NOT IN POSITION)



(NOT IN POSITION)



The site plan and floor plan are not to scale. Measurements are indicative and in metres. Bathes and trees are placed for illustration purposes. Plans should not be relied on. Interested parties should make and rely on their own enquiries. All other information provided has been collected from reliable sources but cannot be guaranteed for accuracy.

21 Cromwell Street, Croydon

STONE

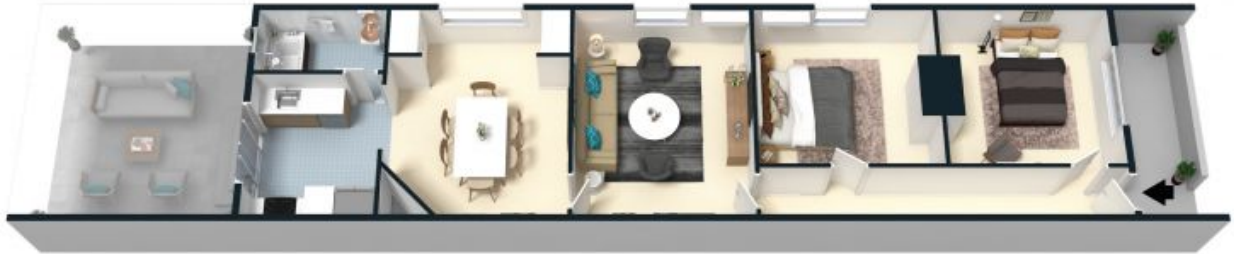

The floor plan is not to scale, measurements are indicative and in metres. All features included in this 3D plan are for inspiration purposes only. This is not an exact replica of the property or the position of exterior elements. Plans should not be relied on. Interested parties should make and rely on their own enquiries.

21 Cromwell Street, Croydon



STONE