



10 Callicoma Road Seaforth, NSW

5

3

2

North Facing Coastal Luxury

Embraced by bushland and possessing a wonderful sense of seclusion and refined luxury, this spectacular family home is a brilliant fusion of classic Hamptons' design and relaxed Australian coastal style. Impeccably crafted and finished throughout, the home offers an expansive floorplan with seamless indoor/outdoor flow and plenty of space and flexibility for a growing family.

- Near new Hamptons detailing including vaulted ceilings with exposed beams and wainscoting
- Gourmet eat-in kitchen with caesarstone island, freestanding gas oven and integrated dishwasher
- Huge butlers' pantry with custom storage, additional oven and fridge/freezer space
- Generous covered north-facing deck with al fresco kitchen including bbq and wine fridge
- Combined kitchen/dining and living, flooded in natural light and flowing out onto deck

Price: Contact Agent
Council Rates: \$508.80 p/q



Maria Cassarino

0411 818 093



Julian Rowe

0412 544 448

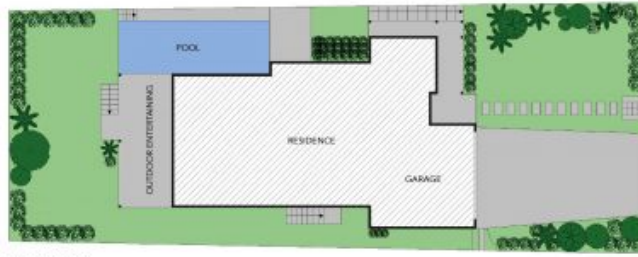

SITE PLAN



GROUND LEVEL



FIRST LEVEL

The site plan and floor plan are not to scale, measurements are indicative and in meters. Rubus and trees are placed for illustration purposes. Plans should not be relied on. Interested parties should make and rely on their own enquiries. All other information provided has been collected from reliable sources but cannot be guaranteed for accuracy.



10 Callicoma Road, Seaforth





GROUND LEVEL



FIRST LEVEL

The floor plan is not to scale, measurements are indicative and in metres. All features included in this 3D plan are for inspiration purposes only. This is not an exact replica of the property or the position of exterior elements. Plans should not be relied on. Interested parties should make and rely on their own enquiries.

10 Callicoma Road, Seaforth

