



10/142 Gladstone Avenue Coniston, NSW 2 1 1

Entry level apartment promises privacy and ultra convenience

Offering low maintenance lifestyle of enviable privacy, this apartment represents an excellent market entry point for both first home buyers and young couples alike. Its refreshed interiors ensure readymade comfort, while a central address promises ultra convenience. This home is within easy walking distance of Coniston Station and bakery, while close to Wollongong CBD.

Price: \$310,000



Michael Schlegel

0418 627 220

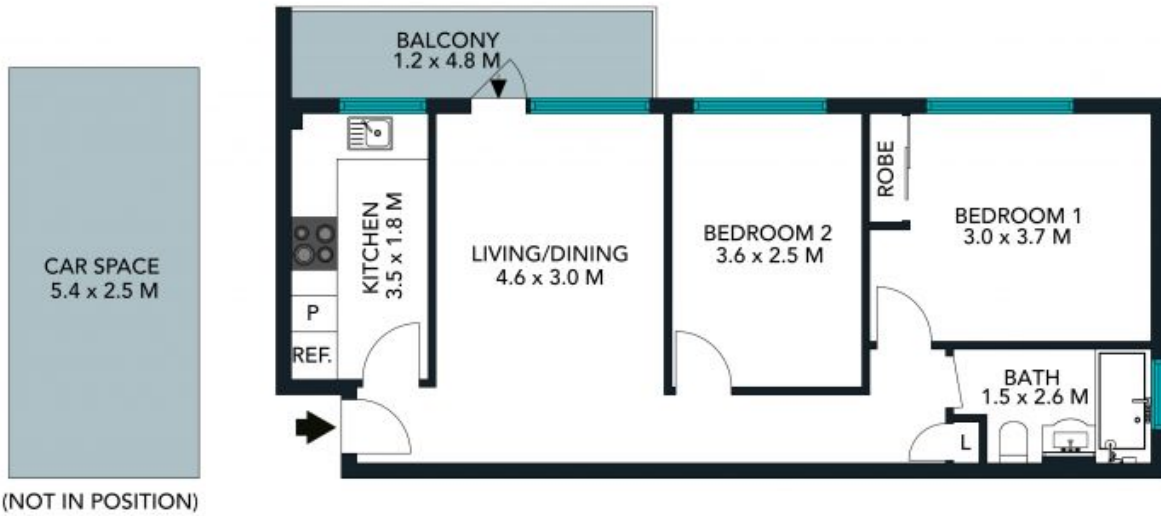

(NOT IN POSITION)



The floor plan is not to scale, measurements are indicative and in metres. Colour elements are not to position. Plans should not be relied on, interested parties should make and rely on their own enquiries. All other information provided has been collected from reliable sources but cannot be guaranteed for accuracy.

10/142 Gladstone Avenue, Coniston





The floor plan is not to scale, measurements are indicative and in metres. All features included in this 3D plan are for inspiration purposes only. This is not an exact replica of the property or the position of exterior elements. Plans should not be relied on. Interested parties should make and rely on their own enquiries.

10/142 Gladstone Avenue, Coniston

