



3/290 Newcastle Road North Lambton, NSW

3 2 1

Brand new townhouses ready to enjoy

Laying claim to a central address and built to exacting standards, quality architects are behind the inspiring open-plan design of these townhouses, created to seamlessly integrate with outdoors and take full advantage of leafy views. With easy off-street access via Arthur Street, they are bound to attract first-home buyers seeking a brand new property or investors looking to take advantage of depreciation benefits. All homes enjoy peace of mind with builders and appliance warranty in place, and each has a slightly varied 3-bedroom/2-bathroom design, so early inspection is a must to find the right fit for you.

Price: \$580,000



Kathleen Matinlassi

0407 244 162



FIRST FLOOR



GROUND FLOOR

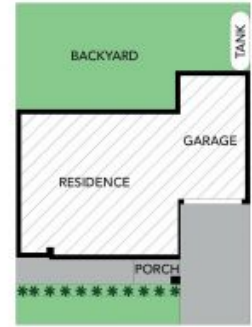

SITE PLAN

The site plan and floor plan are not to scale, measurements are indicative and in metres. Boxes and lines are placed for illustration purposes. Plans should not be relied on. Interested parties should make and rely on their own enquiries. All other information provided has been collected from reliable sources but cannot be guaranteed for accuracy.

Townhouse 1, 290 Newcastle Road, North Lambton





FIRST FLOOR



GROUND FLOOR

The floor plan is not to scale, measurements are indicative and in metres. All features included in this 3D plan are for inspiration purposes only. This is not an exact replica of the property or the position of exterior elements. Plans should not be relied on. Interested parties should make and rely on their own enquiries.

Townhouse 1, 290 Newcastle Road, North Lambton

