



74 Vista Street Sans Souci, NSW



Peninsula hotspot with development upside on 816sqm

Price:

SOLD \$2,405,000 | RAY FADEL

This unique property offers a golden opportunity to acquire a spacious land package in one of the best locations on the peninsula. Set on an impressive 816sqm with a wide 20m frontage approx, this original residence provides the chance to redevelop or subdivide the site to take full advantage of its premium setting (STCA). This popular neighbourhood is easily accessible to all of the area's lifestyle amenities including schools, parks, major shopping centres and is just footsteps to the foreshore.

- Positioned directly opposite Anderson Park and the water's edge
- An elevated position that commands leafy views over the water
- Potential to rebuild or subdivide for duplex development (STCA)
- Existing double brick home is in solid and well-maintained condition
- Occupying a deep 816sqm landholding with a wide 20m frontage
- Walking distance to St George Motor Boat Club and waterfront parks
- A rare opportunity to buy into this sought-after community



Ray Fadel

0413 177 739



SITE PLAN



(NOT IN POSITION)



The site plan and floor plan are not to scale, measurements are indicative and in metres. Shades and lines are placed for illustration purposes. Plans should not be relied on. Interested parties should make and rely on their own enquiries. All other information provided has been collected from reliable sources but cannot be guaranteed for accuracy.

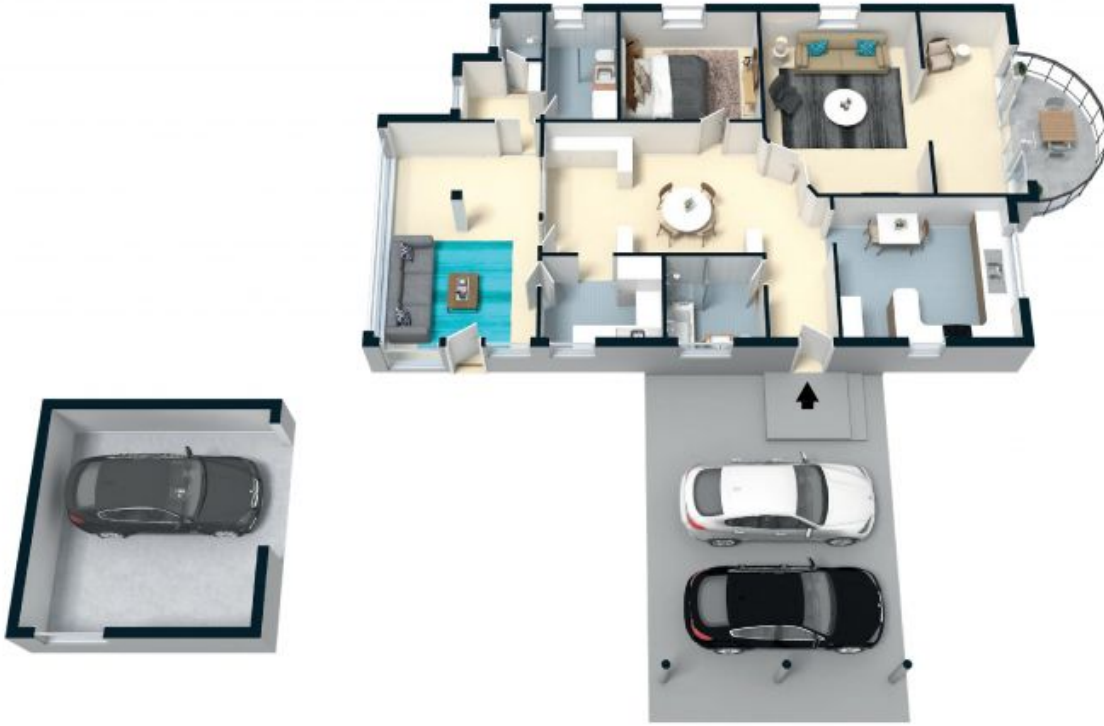

The floor plan is not to scale, measurements are indicative and in metres. All features included in this 3D plan are for inspiration purposes only. This is not an exact replica of the property or the position of exterior elements. Plans should not be relied on. Interested parties should make and rely on their own enquiries.

74 Vista Street, Sans Souci



STONE