

56 Springwood Street Ettalong Beach, NSW



If you are thinking of selling, speak to Helen & Christel to find out how we can achieve the best price for you! 0476 001 295

This quaint cottage offers rear lane access centrally located with in close proximity to both the beach and rail. Perfect for the first home buyer, investor or those looking for a project.

Price: \$565,000
Council Rates: \$1,418.81/year (approx)
Water Rates: \$684.16/year (approx)



Helen Hughes

0418 220 622



Christel Renton

0417 208 314

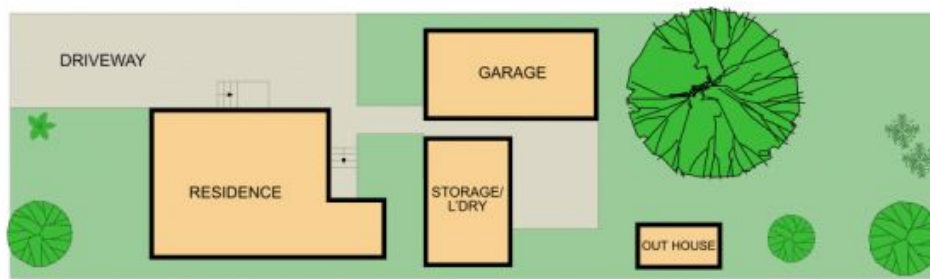
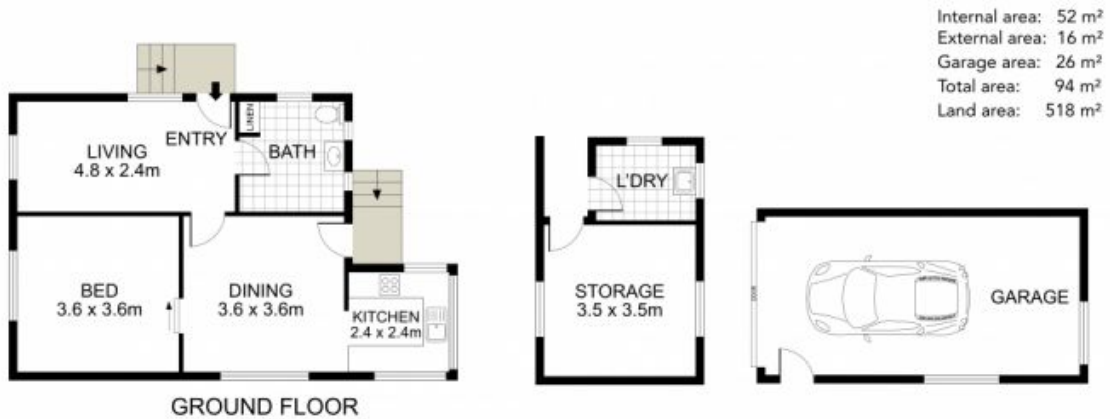

56 SPRINGWOOD STREET, ETTALONG BEACH

PLANS SHOWN ONLY INDICATIVE OF LAYOUT. DIMENSIONS ARE APPROXIMATE.
 Measurements are approximate and not to scale. The vendor, agency and supplier will accept no liability for its accuracy. Interested parties are advised to make their own independent enquiries.