



19/140-150 New Canterbury Road Petersham, NSW

1 1 1

Warehouse style sun drenched, immaculate one bedroom apartment

Superbly located in the heart of Petersham is this expansive 84 sqm warehouse style apartment including parking. Drenched with sunlight it is quietly positioned in a security building, offers low maintenance and a superb opportunity for first home buyers and investors. Enhanced with freshly painted interiors and new floating floors throughout, this premium location is situated amongst a variety of lifestyle attractions the inner west has to offer.

Price:

Contact Agent



Frederico Fraga-Matos

0450 100 100



Giorgio Koula

0417 224 341

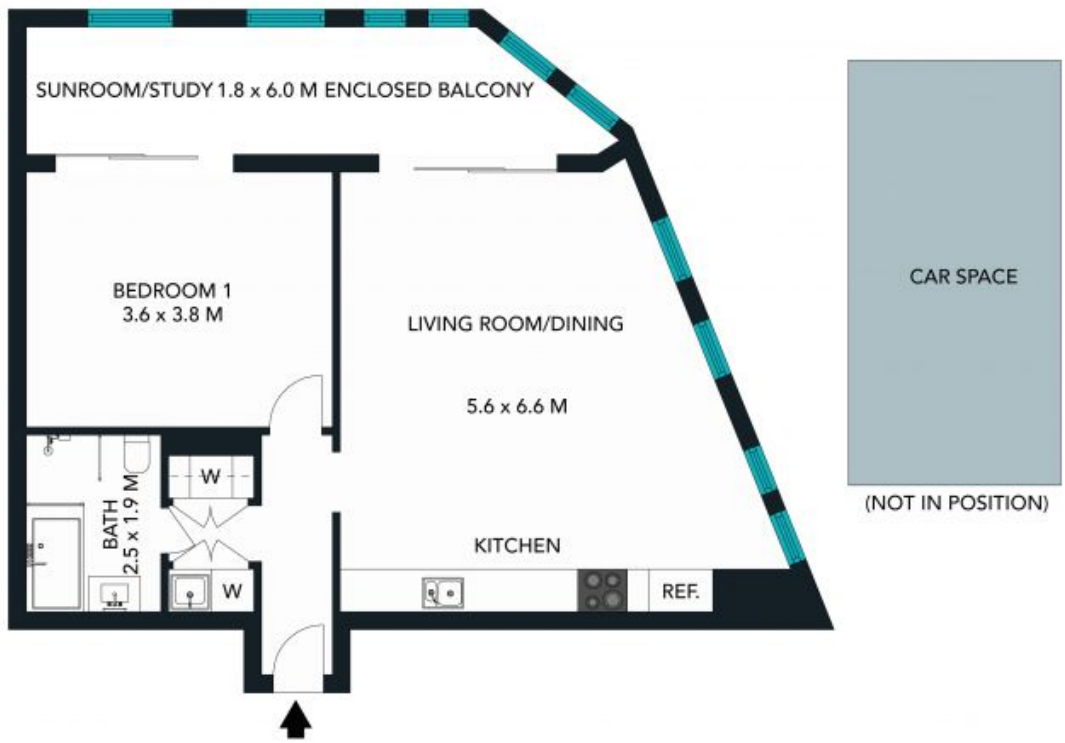

The floor plan is not to scale, measurements are indicative and in metres. Exterior elements are not to position. Plans should not be relied on. Interested parties should make and rely on their own enquiries. All other information provided has been collected from reliable sources but cannot be guaranteed for accuracy.



19/140 New Canterbury Rd, Petersham



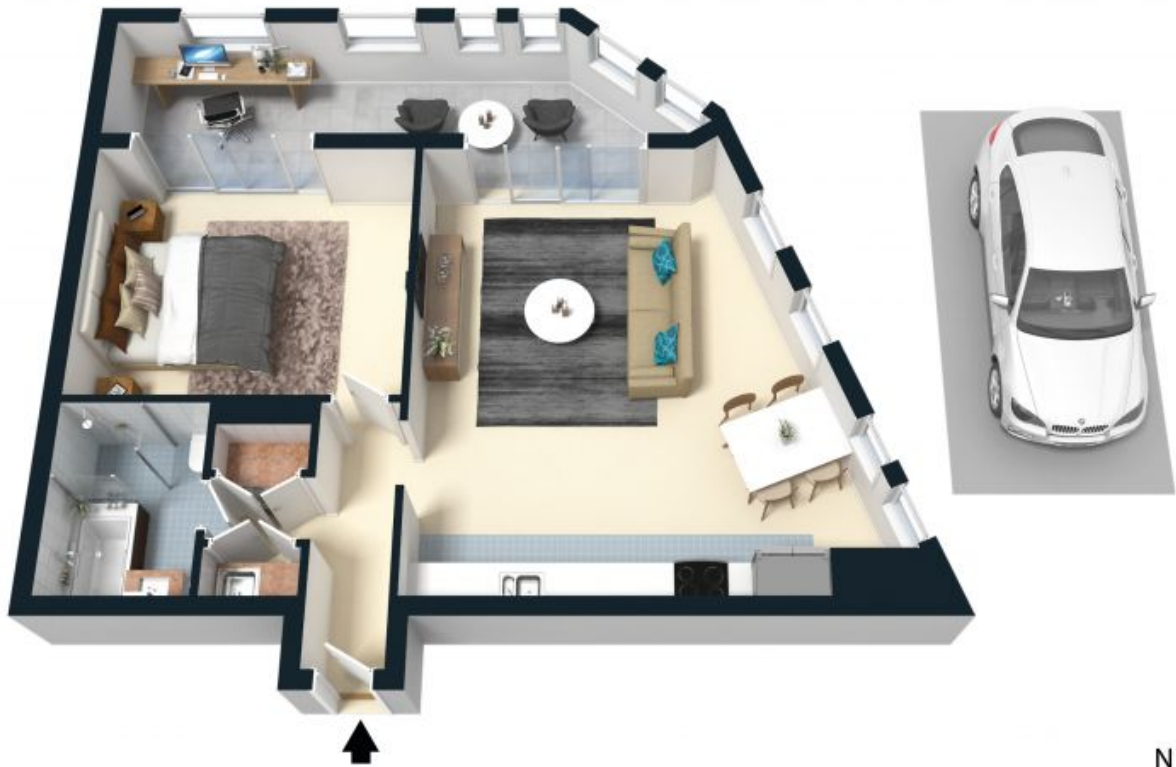

The floor plan is not to scale, measurements are indicative and in metres. All features included in this 3D plan are for inspiration purposes only. This is not an exact replica of the property or the position of exterior elements. Plans should not be relied on. Interested parties should make and rely on their own enquiries.

19/140 New Canterbury Rd, Petersham

