



339/51 The Esplanade ETTALONG BEACH, NSW



Investors take note currently rented at \$420 per week

Price: \$269,000

Large 18m2 north facing balcony with mountain views fully furnished 1 bedroom apartment with underground parking and lift access. Level 1 of the resort features a resort pool, outdoor spa and large sun deck. This apartment feels spacious airy and bright. Outgoings Strata \$1423.60 per quarter.



Helen Hughes

0418 220 622

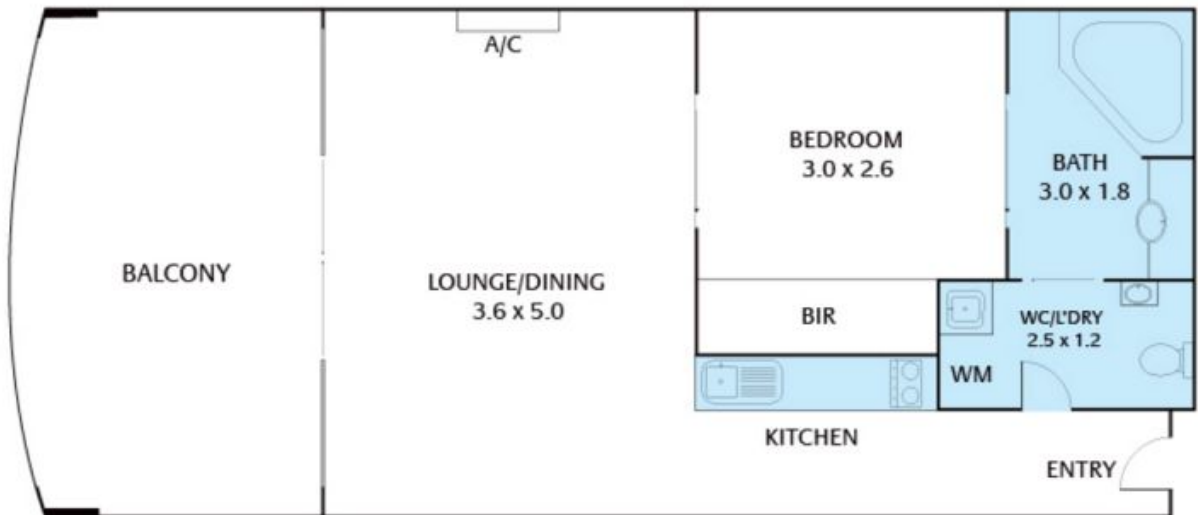

431/51-54 The Esplanade, Ettalong Beach

Whilst every attempt has been made to ensure the accuracy of the floor plan contained here, measurements of doors, windows, seats and any other items are approximate and no responsibility is taken for any error, omission, or misstatement. This plan is for illustrative purposes only and should be used as such by any prospective purchaser.



INTERNAL AREA : 43sqm