



23A Deakin Place West Pennant Hills, NSW

3

2

2

Torrens title executive duplex in Murray Farm Primary catchment

Boasting a prized cul-de-sac address, close to Richard Webb Reserve, this bright modern duplex offers low maintenance living with a private aspect in a quiet, convenient setting. The home occupies a landscaped garden block with elevated leafy outlooks and is desirably positioned for easy access to shops, transport and in the catchment for popular Murray Farm Primary School.

Price: Contact Agent

Council Rates: \$386.00 p/q

Water Rates: \$177.00 p/q



Chloe Mawass

0431 983 240



James Ramsay

0420 665 913

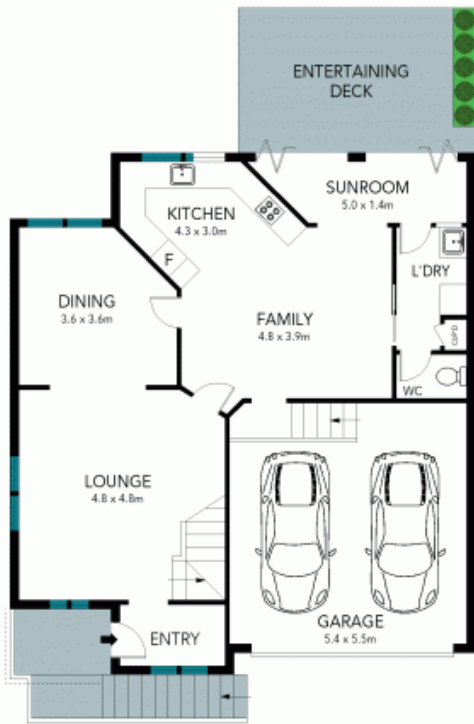

GROUND FLOOR



FIRST FLOOR



SITE PLAN

The floor plan is not to scale; measurements are indicative and in metres. Exterior elements are not in position. Plans should not be relied on. Interested parties should make and rely on their own enquiries.

23A Deakin Place, West Pennant Hills

