

4 Lord Howe Avenue Shell Cove, NSW

4 2 2

Grand opportunity in popular locale

Set for the ever growing family, this beautiful home combines size, comfort and versatility. An ideal place for your family to grow, this double storey layout is inviting and light-filled throughout. This sunny retreat is on an easy to manage block in a quiet street, a stroll to village shops, Shell Cove Marina and beaches.

Price: \$795 per week

Bond: \$3,180

Available Date: 15/10/2021



Darnell Haselau

0426 400 240



FIRST FLOOR

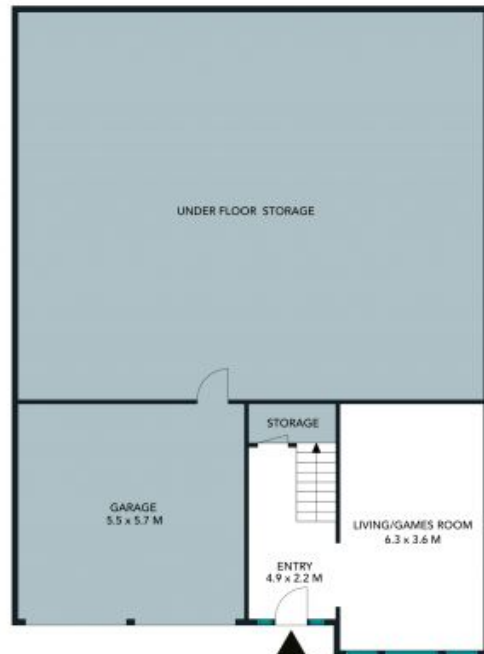

GROUND FLOOR

The floor plan is not to scale, measurements are indicative and in metres. Exterior elements are not in position. Plans should not be relied on. Interested parties should make and rely on their own enquiries.

4 Lord Howe Avenue, Shell Cove

