



24/4-6 Hunter Street Lewisham, NSW

2 

1 

1 

North facing apartment in ultra-convenient location

Presenting an outstanding opportunity for first home buyers and investors alike with its easy floor plan and popular setting. Graciously positioned with its north facing interiors it offers an excellent low-maintenance option in a super convenient inner west location. Step out the front door just a few steps away from Lewisham train station, light rail, bus transport and strolling distance to Summer Hill & Petersham's village cafes.

Price:

Contact Agent



Frederico Fraga-Matos

0450 100 100



Joseph Tropiano

0401 002 211

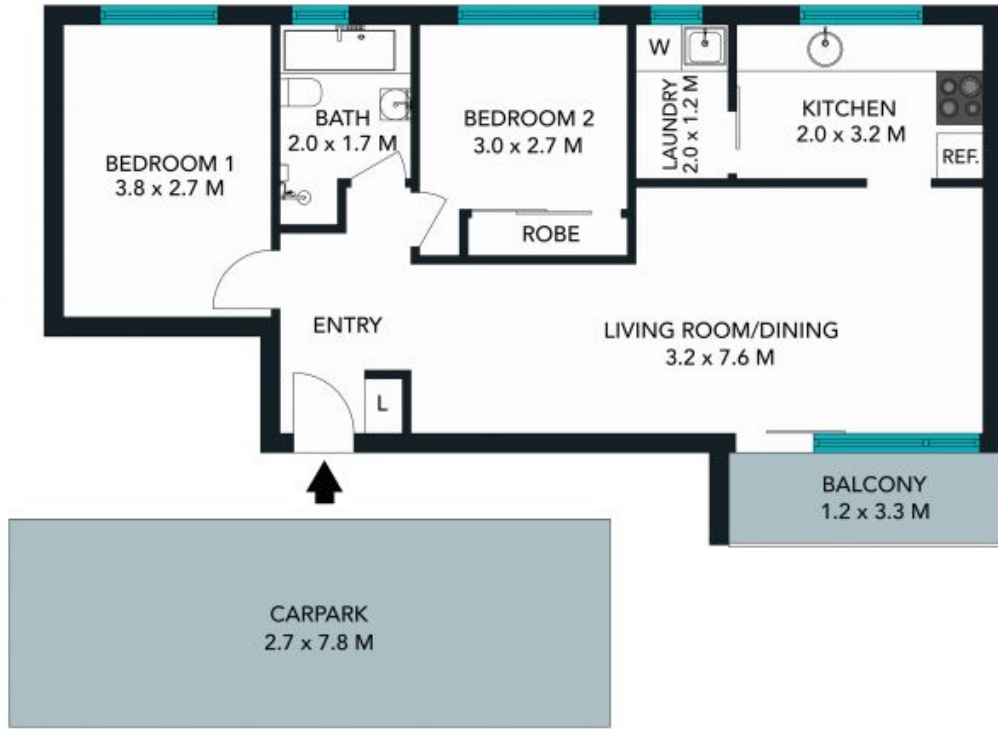

(NOT IN POSITION)

The floor plan to not to scale measurements are indicative and in metres. Exterior elements are not to position. Plans should not be relied on. Interested parties should make and rely on their own enquiries. All other information provided has been collected from reliable sources but cannot be guaranteed for accuracy.

24/4 Hunter Street, Lewisham





The floor plan is not to scale; measurements are indicative and in metres. All features included in this 3D plan are for inspiration purposes only. This is not an exact replica of the property or the position of exterior elements. Plans should not be relied on. Interested parties should make and rely on their own enquiries.

24/4 Hunter Street, Lewisham

