



8 Rawson Street Kurri Kurri, NSW



Family home, studio and rear lane access

This well loved home will satisfy a wide range of lifestyle needs. Families or investors will love the flexibility of a teenage retreat, the convenience of rear lane access and its quiet location 1km from the centre of town. The homes light-filled interiors are freshly presented and boast three double bedrooms, connected living areas and a gas-equipped kitchen.

Price: \$415,000
Council Rates: \$374.00 p/q
Water Rates: \$750.00/year (approx)



Renee Bean-Wyper

0403 325 076



STUDIO/TEENAGE RETREAT

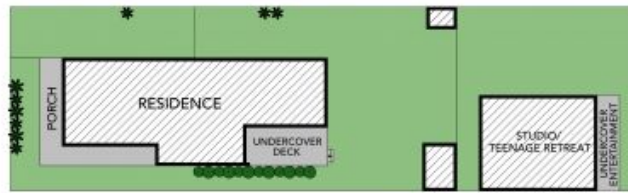

SITE PLAN



The site plan and floor plan are not to scale, measurements are indicative and in metres. Bushes and trees are placed for illustration purposes. Plans should not be relied on. Interested parties should make and rely on their own enquiries. All other information provided has been collected from reliable sources but cannot be guaranteed for accuracy.



8 Rawson Street, Kurri Kurri





STUDIO/TEENAGE RETREAT



The floor plan is not to scale, measurements are indicative and in metres. All features included in this 3D plan are for inspiration purposes only. This is not an exact replica of the property or the position of exterior elements. Plans should not be relied on. Interested parties should make and rely on their own enquiries.

8 Rawson Street, Kurri Kurri

