



14/510 Pacific Highway Killara, NSW



### Sunny sanctuary positioned for lifestyle

Defined by its fluid and large open plan layout, occupying the building's prized North-East corner, the spacious accommodation enjoys a rare sense of peace and privacy with a serene leafy outlook for you to sit back in style and soak up the sun. A beautifully renovated double brick apartment offering:

Price:

Contact Agent



**Andrew Braid**

0404 979 597



(NOT IN POSITION)



(NOT IN POSITION)



The floor plan is not to scale, measurements are indicative and in metres. Colour statements are not in position. Plans should not be relied on. Interested parties should make and rely on their own enquiries. All other information provided has been collected from reliable sources but cannot be guaranteed for accuracy.

14/510 Pacific Highway, Killara



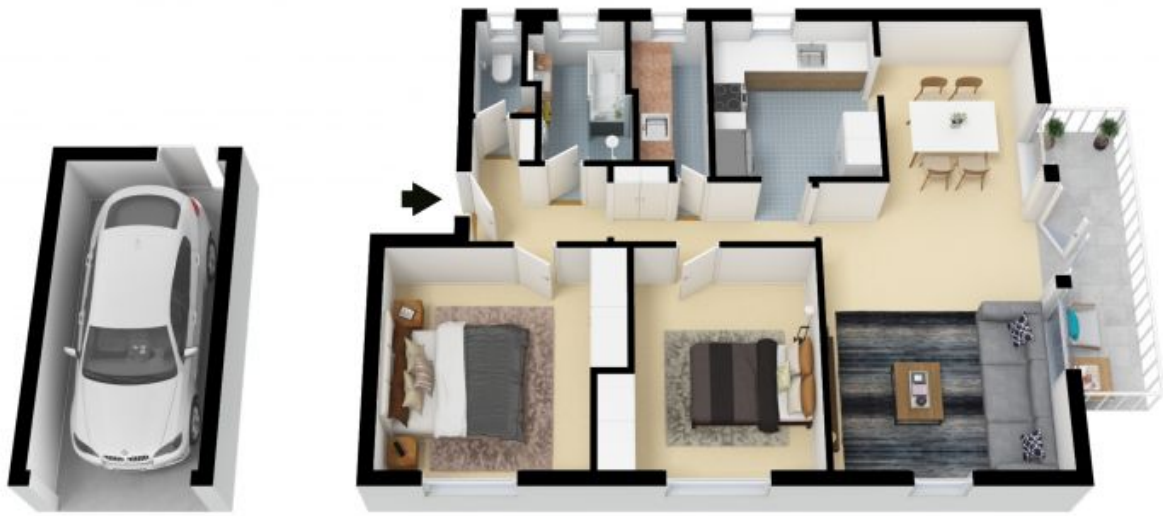

The floor plan is not to scale, measurements are indicative and in metres. All features included in this 3D plan are for inspiration purposes only. This is not an exact replica of the property or the position of exterior elements. Plans should not be relied on. Interested parties should make and rely on their own enquiries.



14/510 Pacific Highway, Killara

