



810/20 Chisholm Street Wolli Creek, NSW

2 1 1

SOLD BY SAM ABBAS 0406 750 075

Poised over the Cooks River and capturing stunning vistas from every angle, this modern home offers serene, resort-style living minutes from the CBD. Floor-to-ceiling glass captures breathtaking sunsets from the spacious open-plan living area, while a north-facing enclosed balcony draws abundant natural light into the home. A jewel in the crown of the master planned Discovery Point community, the apartment's striking building is moment from riverside parklands, express city trains and a bustling piazza-style dining and retail precinct.

Price: \$780,000



Sam Abbas

0406 750 075



Tyler Taylor

0402 462 405

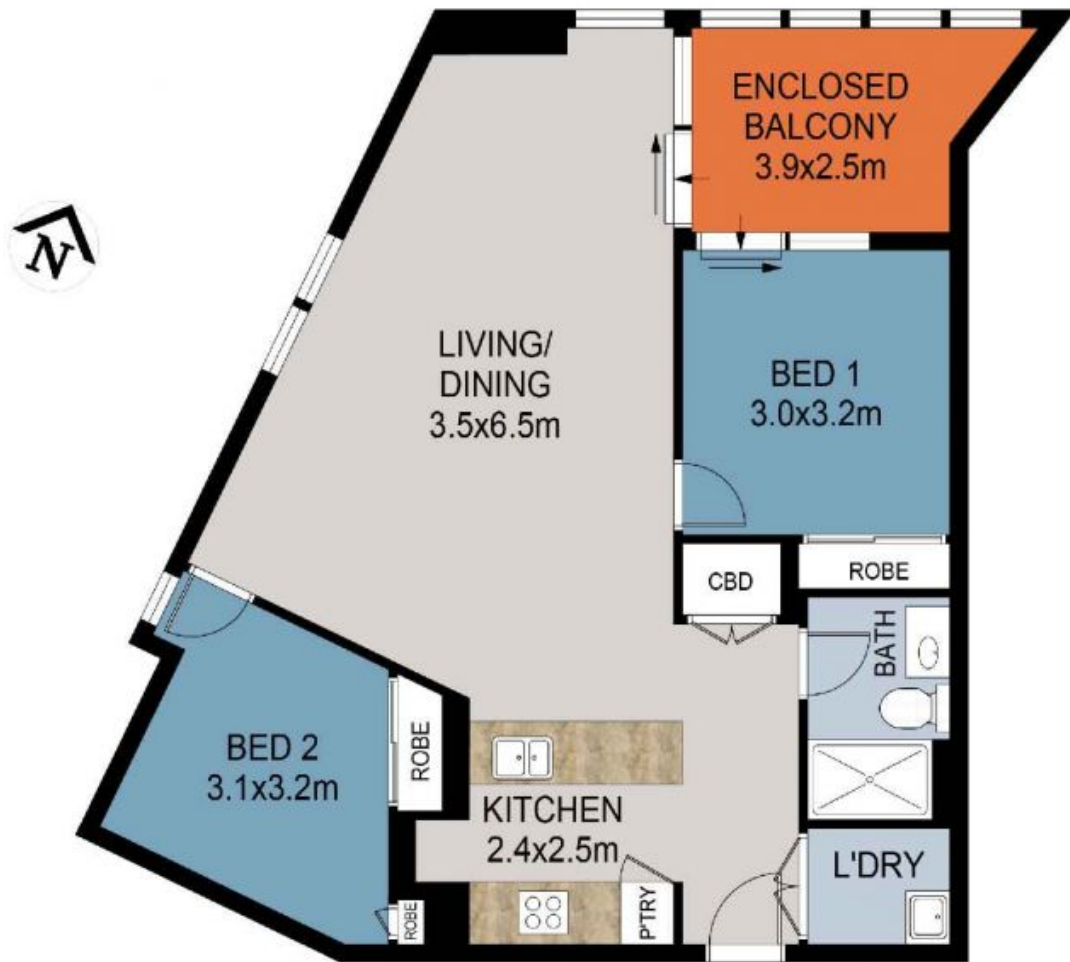

LEVEL EIGHT



SECURE
CAR SPACE
2.8x5.3m

BASEMENT

DISCLAIMER: THIS IS FOR ILLUSTRATIVE PURPOSES ONLY.
ALL DIMENSIONS ARE APPROXIMATE AND IT DOES NOT
CONSTITUTE PART OF ANY LEGAL DOCUMENTS.

ADDRESS:

810/20 CHISHOLM STREET, WOLLI CREEK