

908/395 Princes Highway Rockdale, NSW 2  2  1 

Brand new, with view

True to its name, this glamorous apartment in the award-winning 'View' building has a bird's eye outlook across to Botany Bay. Set high in the complex, there's so much to love about this brand new home, from the open-plan living space, to its sleek modern finishes and striking curved exterior. It will put you within 20 minutes of the CBD, as Banksia and Rockdale Station are footsteps away, and is a stroll from restaurants, shops and amenities. Swim and feel the sand between your toes any day of the week, with beautiful Lady Robinson's Beach within a few minutes' drive.

Price: Sold



George Kambouroglou
0422 421 111



Sam Abbas
0406 750 075

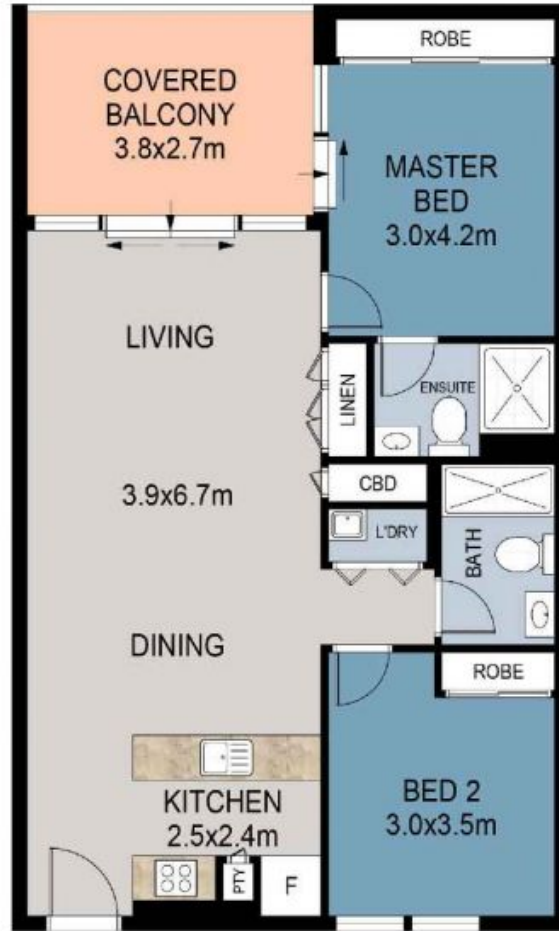

LEVEL NINE



BASEMENT

DISCLAIMER: THIS IS FOR ILLUSTRATIVE PURPOSES ONLY. ALL DIMENSIONS ARE APPROXIMATE AND IT DOES NOT CONSTITUTE PART OF ANY LEGAL DOCUMENTS.

ADDRESS:

908/395 PRINCES HIGHWAY, ROCKDALE