



4 Kellor Court Upper Coomera, QLD

4 2 2

A standout choice for luxury suburban living

At the forefront of contemporary design, this architecturally spectacular 2009 built residence establishes a new benchmark in terms of style, luxury and state of the art. Offering a distinctive and modern appeal complimented by engaging and expansive living options, is this majestic, standout choice for residential living. As breathtakingly beautiful as it is effortlessly functional, this magnificent family domain enjoys a tranquil north facing position in an exclusive precinct.

Price: \$765,000 - \$805,000
Council Rates: \$1,600.00/year (approx)
Water Rates: \$400.00 p/q



Shane Evans

0416 193 663



Shane Evans

0416 193 663

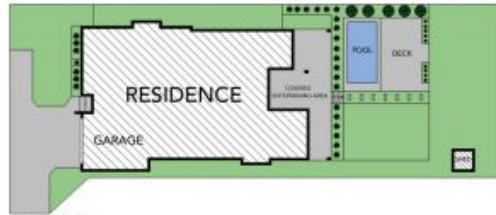

SITE PLAN



Internal Living: 364 sqm approx
 External Living: 42 sqm approx
 Total Living Area: 368 sqm approx

The site plan and floor plan are not to scale, measurements are indicative and in metres. Boxes and lines are placed for illustration purposes. Plans should not be relied on. Interested parties should make and rely on their own enquiries. All other information provided has been collected from reliable sources but cannot be guaranteed for accuracy.

4 Kellor Court, Upper Coomera





Internal Living: 356 sqm approx
External Living: 42 sqm approx
Total Living Area: 398 sqm approx

The floor plan is not to scale; measurements are indicative and in metres. All features included in this 3D plan are for inspiration purposes only. This is not an exact replica of the property or the position of exterior elements. Plans should not be relied on. Interested parties should make and rely on their own enquiries.

4 Kellor Court, Upper Coomera



STONE