



195 Enmore Road Enmore, NSW

Retail & residential package with upside potential

On offer is this rare opportunity to secure a prime commercial/residential property package and capitalise on its numerous creative possibilities. Occupying a premium position with wide frontage onto Enmore Road and rear car access, this retail space and upstairs apartment are ready to occupy, lease out or explore future development potential, subject to approval.

Price: Contact Agent
Council Rates: \$1,008.25 p/q
Water Rates: \$280.00 p/q
Strata Rates: \$0.00 p/q



Adrian Vassallo

0406 484 994



Joseph Tropiano

0401 002 211

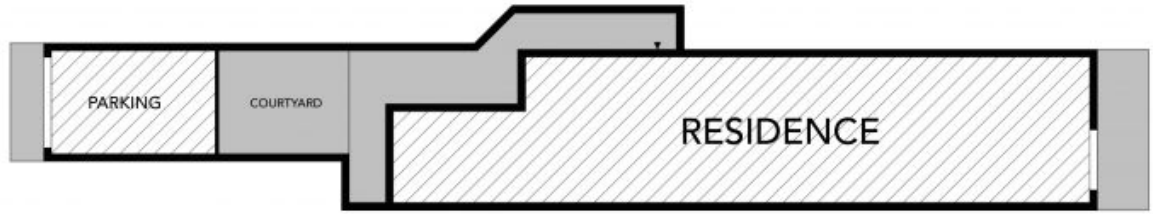

SITE PLAN

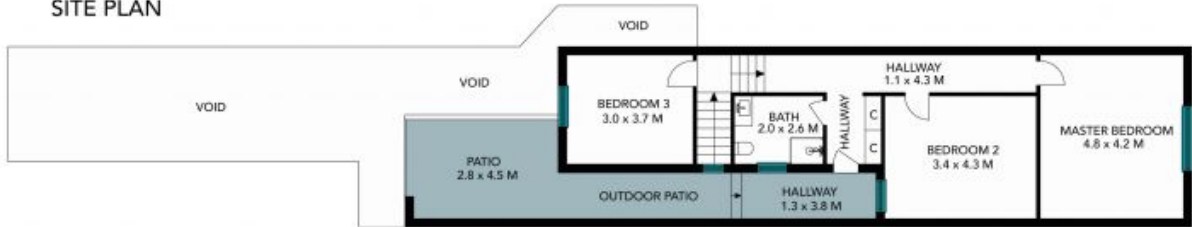

FIRST FLOOR



GROUND FLOOR

The site plan and floor plan are not to scale, measurements are indicative and in meters. Boxes and lines are placed for illustration purposes. Plans should not be relied on. Interested parties should make and rely on their own enquiries. All other information provided has been collected from reliable sources but cannot be guaranteed for accuracy.





FIRST FLOOR



GROUND FLOOR

The floor plan is not to scale, measurements are indicative and in meters. All features included in this 3D plan are for inspiration purposes only. This is not an exact replica of the property or the position of exterior elements. Plans should not be relied on. Interested parties should make and rely on their own enquiries.

195 Enmore Road, Enmore

