



5 Romford Road Epping, NSW



**Great Living, Great Location.**

Sold at Auction - 7th of Nov, 2020

18 Registered bidders.

38 bids

\$380,000 Over the reserve price

**SOLD BY JAMES KWON**

CONTACT: 0414 988 891

This double storey solid home is set on a generous 765sqm parcel near level land with corner position in one of Epping's desired location within the Epping Heights Public School, Cheltenham Girls & Epping Boys High school catchment area. Double brick construction with clad extension upstairs, high ceilings, floorboards and multiple living area is very ideal for growing family.

**Price:**

Sold



**James Kwon**

0414 988 891

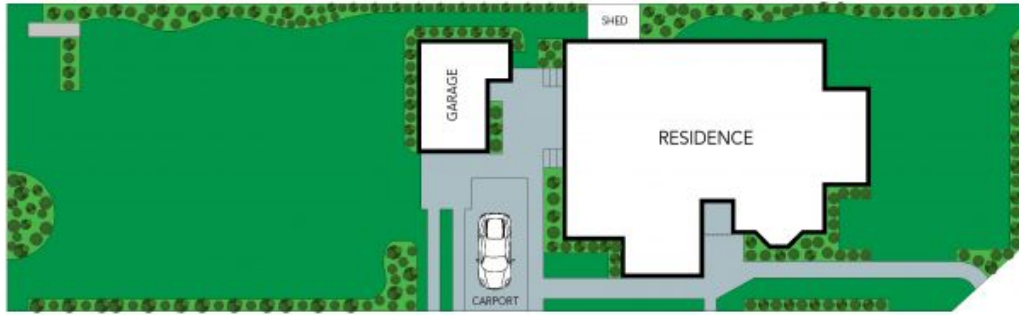

SITE PLAN



GROUND FLOOR

GROUND FLOOR

FIRST FLOOR

The floor plan is not to scale; measurements are indicative and in metres. Exterior elements are not in position. Plans should not be relied on. Interested parties should make and rely on their own enquiries.

5 Romford Road, Epping

