



5 Bella Vista Street HEATHCOTE, NSW

4 2 2

Spacious Family Home On Nature's Doorstep

Surrounded by a breathtaking view of Heathcote National Park, this warm welcoming family home is nestled within a quiet street in a serene location. Multiple living spaces, fabulous alfresco entertaining deck and a large sun-drenched yard with National Park access provide an idyllic, peaceful environment for growing families

- Spacious, light-filled formal living and dining rooms
- Updated kitchen flows to open plan dining and living with air-conditioning
- Three great sized bedrooms with built-in robes, generous main with ensuite and walk-in robe
- Good size family bathroom with separate bath and shower plus separate WC
- Ducted air-conditioning throughout upper level
- Internal laundry with side yard access
- Extensive undercover alfresco entertaining space with fabulous bush outlook
- Large, sun-drenched level grass yard with direct National Park access and garden shed

Price: Guide \$950,000 - \$1,045,000



Rhys Christofa

0415 684 877

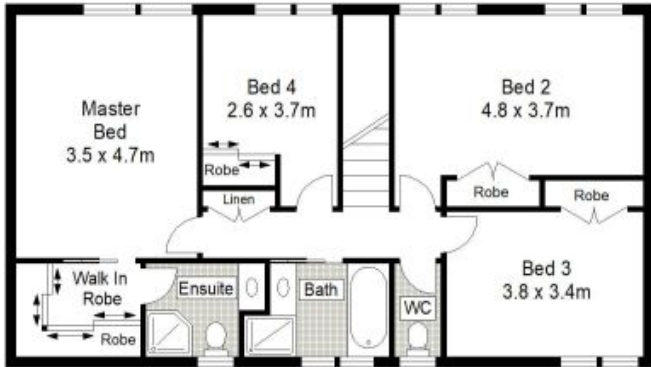

FIRST FLOOR



GROUND FLOOR

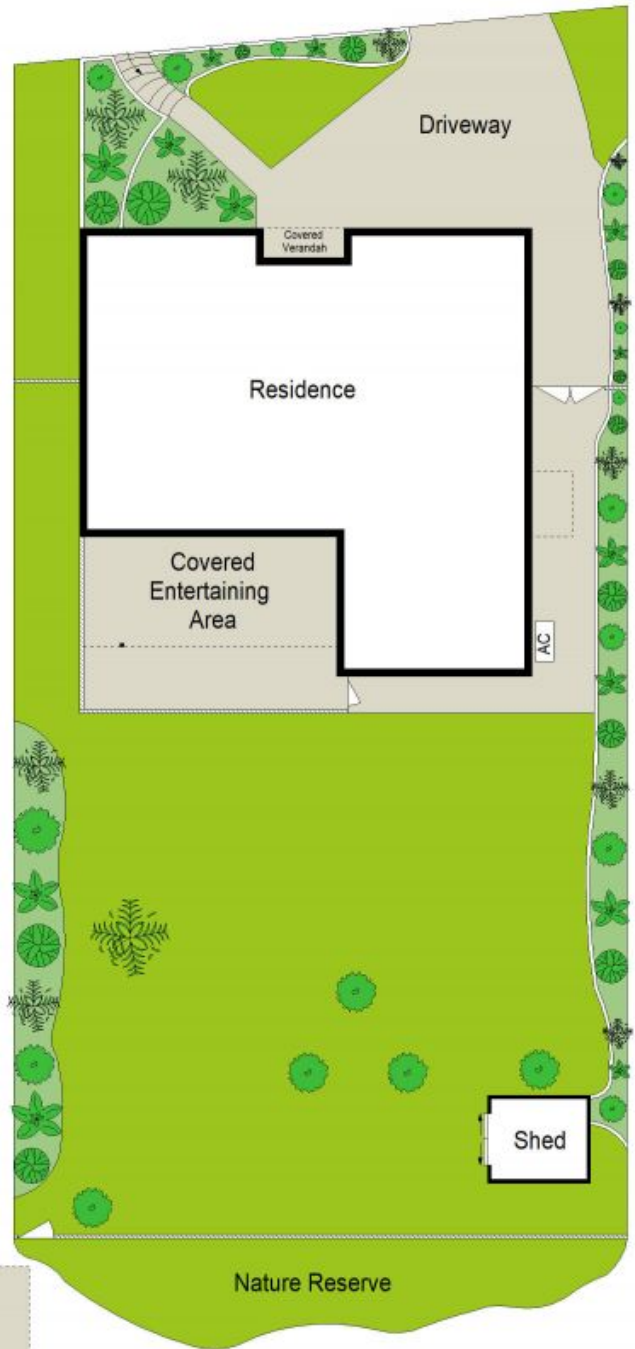

SITE PLAN (NOT TO SCALE)

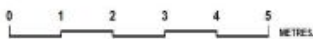

Scale in metres. Indicative only. Dimensions are approximate. All information contained herein is gathered from sources we believe to be reliable. However we cannot guarantee its accuracy and interested persons should rely on their own enquiries.

