

10/975 Old Princes Highway ENGADINE, NSW



Convenient Quintessential Living

Located in the highly sought Vue complex in the heart of Engadine is this neatly presented apartment is perfect for families, downsizers and investors. Providing stunning views of the city and Royal National Park with a generous floor plan and convenient lifestyle, all within walking distance to Engadine town centre

- Following the current social distancing restrictions, we are conducting inspections by appointment to avoid crowding. To book an inspection time please call Rhys Christofa on 0415 684 469
- This large, light-filled apartment with air-conditioning utilises open plan living to stunning effect with a seamless flow to the fabulous undercover balcony with beautiful views
- Gourmet kitchen with stone benchtops, glass splash back, gas cooking, integrated dishwasher and quality appliances
- Two spacious bedrooms with built-in robes designed with large windows offering abundant natural light
- Modern, stylish family bathroom with separate bath and shower
- Internal laundry with storage cupboards

Price:

Guide \$720,000 - \$759,000



Rhys Christofa

0415 684 877

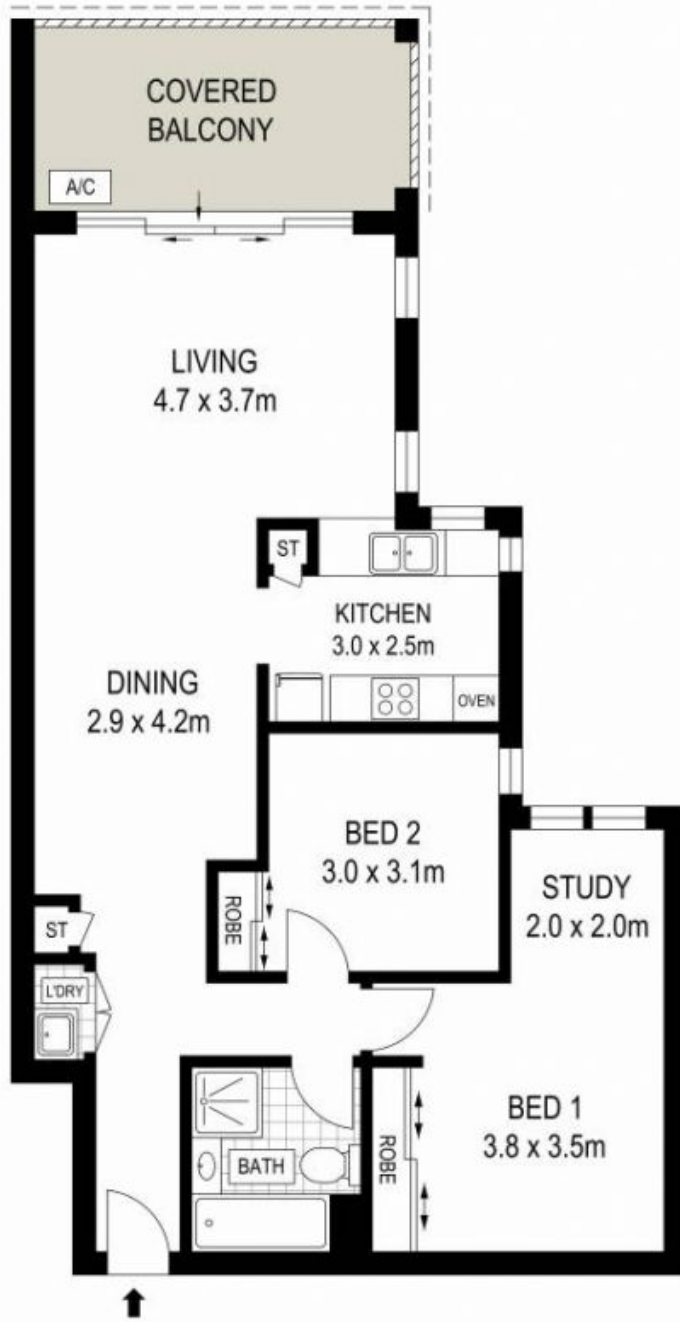

SECOND FLOOR

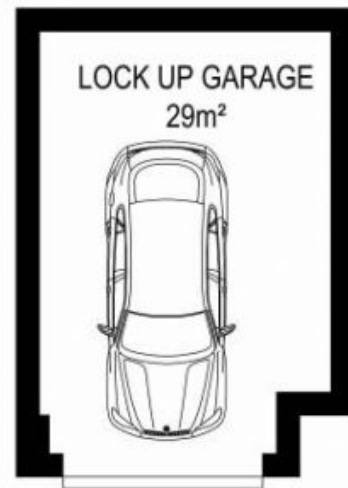

BASEMENT

ADDRESS:
10/975 Old Princes Highway, Engadine



DISCLAIMER: THIS IS FOR ILLUSTRATIVE PURPOSES ONLY, ALL DIMENSIONS ARE APPROXIMATE AND IT DOES NOT CONSTITUTE PART OF ANY LEGAL DOCUMENTS.