

68 Kent Street Epping, NSW

3  1  2 

Perfect Start - Premium Location
Appx 1.1km walk to Epping Station.

Peacefully set in a private leafy and perfect location, this single level brick family home is neatly presented and boasts light-filled interiors with high ornate ceilings. Within 1.1kms easy walking distance to Epping station, all amenities and set on approx. 765sqm sqm with 17.2m frontage. This lovely home presents an outstanding opportunity to purchase in a highly sought-after one of most desired locale .

Price: Sold \$1,680,000



James Kwon
0414 988 891

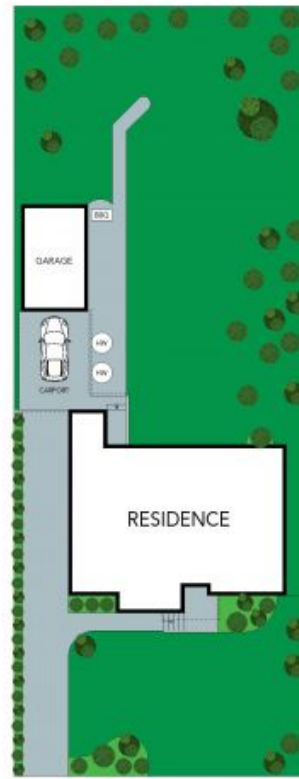

SITE PLAN

The floor plan is not to scale; measurements are indicative and in metres. Exterior elements are not in position. Plans should not be relied on. Interested parties should make and rely on their own enquiries.

68 Kent Street, Epping

