



1 Tamar Street Sutherland, NSW

3

2

1

Exciting property to capitalise on premier locale

A delightful property that presents an excellent opportunity to refurbish or redevelop (STCA). Set on a sunny corner block in Sutherland's desirable western fringe, this appealing cottage with elevated views over the Woronora River, is just a short stroll to Sutherland Station, shops, cafes and both public and Catholic schools.

Price: Contact Agent

Council Rates: \$497.00 p/q

Water Rates: \$147.00 p/q



Will Soulos

0403 065 608



The floor plan is not to scale, measurements are indicative and in metres. All features included in this 3D plan are for inspiration purposes only. This is not an exact replica of the property or the position of exterior elements. Plans should not be relied on. Interested parties should make and rely on their own enquiries.

1 Tamar Street, Sutherland



STONE

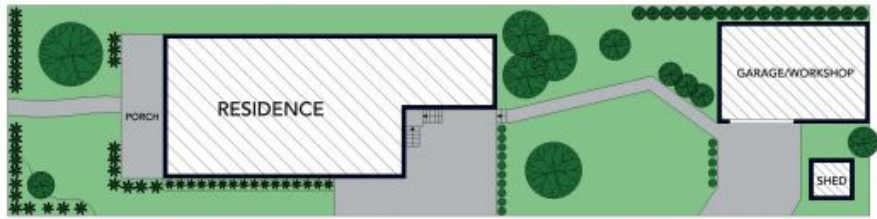

SITE PLAN

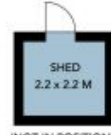

(NOT IN POSITION)



(NOT IN POSITION)



The site plan and floor plan are not to scale, measurements are indicative and in metres. Shades and lines are placed for illustration purposes. Plans should not be relied on. Interested parties should make and rely on their own enquiries. All other information provided has been collected from reliable sources but cannot be guaranteed for accuracy.