

STONE



10/25 Addison Road Manly, NSW



Contemporary apartment with breathtaking views across the Harbour

This light filled waterfront apartment located on the prestigious Eastern Hill is immersed in harbour views that take in everything from Little Manly Beach and Sydney Heads to the city skyline and North Harbour. A leisurely stroll from Manly's pristine harbour and ocean beaches, the wharf and cosmopolitan eateries.

Price: Holding deposit taken

Bond: \$2,780

Available Date: 05/12/2020



Zoe Thackeray

0449 167 420

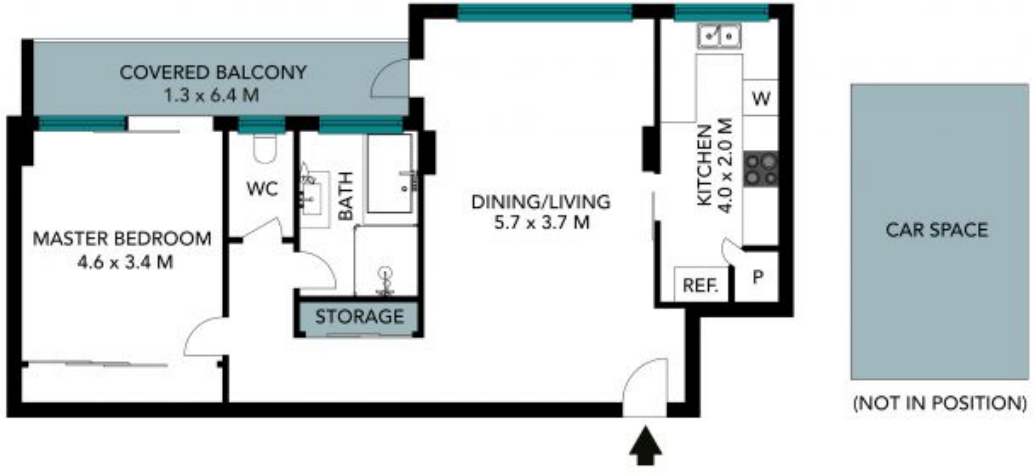

The floor plan is not to scale, measurements are indicative and in metres. Colour elements are not to position. Plans should not be relied on. Interested parties should make and rely on their own enquiries. All other information provided has been collected from reliable sources but cannot be guaranteed for accuracy.



10/25 Addison Road, Manly





The floor plan is not to scale, measurements are indicative and in metres. All features included in this 3D plan are for inspiration purposes only. This is not an exact replica of the property or the position of exterior elements. Plans should not be relied on. Interested parties should make and rely on their own enquiries.



10/25 Addison Road, Manly

