



1549 Mount View Road Millfield, NSW



View-swept acreage with barn

A spacious property located in popular Millfield displaying all the stunning views this area is renowned for could easily be the rural retreat on your wish list. Complete with a well-appointed barn that's positioned perfectly on the 3.32ha block, this opportunity blends privacy with picture-postcard beauty, making it an idyllic getaway. Please note this property does not have a dwelling entitlement.

- Over 8 acres of picturesque land with sweeping views to mountain ranges
- Well-placed barn featuring a slow combustion fireplace and lofts at each end
- Stylish gas-appointed kitchen, modern bathroom and toilet, small study
- Double French doors to front verandah, rear verandah with laundry
- Double garage with power, six solar panels producing 900 watts
- The barn is serviced by 38,000l of water tank storage and NBN satellite dish
- Quality fertile land suited to an array of agricultural pursuits, seasonal creek
- Large variety of fruit trees, two paddocks, day yard for horses, two dams

Price: Contact Agent

Council Rates: \$341.00 p/q



Michael Hurley

0491 012 003



The floor plan is not to scale, measurements are indicative and in metres. All features included in this 3D plan are for inspiration purposes only. This is not an exact replica of the property or the position of exterior elements. Plans should not be relied on. Interested parties should make and rely on their own enquiries.



1549 Mount View Road, Millfield





SITE PLAN

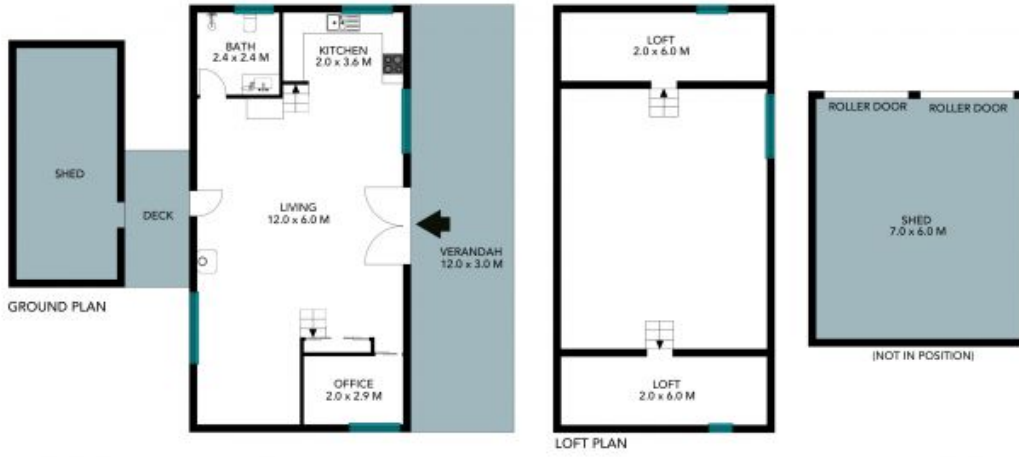

GROUND PLAN

LOFT PLAN

The site plan and floor plan are not to scale, measurements are indicative and in metres. Bushes and trees are placed for illustration purposes. Plans should not be relied on. Interested parties should make and rely on their own enquiries. All other information provided has been collected from reliable sources but cannot be guaranteed for accuracy.



1549 Mount View Road, Millfield

