



57 Seaview Close Eleebana, NSW

5

2

2

Spacious grandeur for the family

Set amidst natural reserve while offering a rare flat yard space, this stunning home celebrates the very essence of bushland living minutes from Lake Macquarie. Presenting a prized family lifestyle with big windows blurring the lines between inside and out, this homes defining features are vaulted 5m ceilings, a sparkling inground pool and design principles that keep the home cool in summer and warm in winter.

Price: \$930,000



Kathleen Matinlassi

0407 244 162



FIRST FLOOR



SITE PLAN

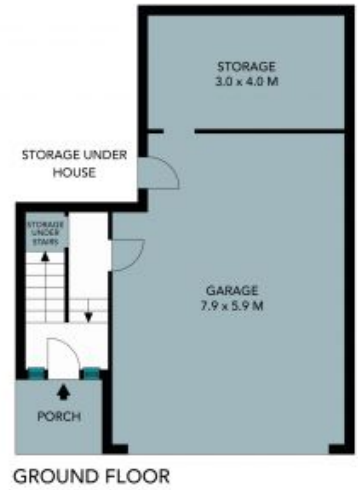

GROUND FLOOR



The site plan and floor plan are not to scale, measurements are indicative and in meters. Robes and trees are placed for illustration purposes. Plans should not be relied on. Interested parties should make and rely on their own enquiries. All other information provided has been collected from reliable sources but cannot be guaranteed for accuracy.



FIRST FLOOR



GROUND FLOOR

The floor plan is not to scale, measurements are indicative and in metres. All features included in this 3D plan are for inspiration purposes only. This is not an exact replica of the property or the position of exterior elements. Plans should not be relied on. Interested parties should make and rely on their own enquiries.

57 Seaview Close, Eleebana

