

235 Sydney Road Fairlight, NSW

4

3

1

### Freestanding character home on a private garden oasis

Rising majestically above its solid sandstone foundations with a perfect north aspect and sweeping 180 degree district views, this beautifully remastered character home provides a bespoke haven of elegance, luxury and privacy. Showcasing open plan living and dining spaces and seamless flow to a series of private terraces, it's only a five minute stroll to the Manly West primary school and Balgowlah or Fairlight Village.

Price: \$2,450,000



**Eddy Piddington**

0414 333 907



**Michael Egan**

0499 172 009

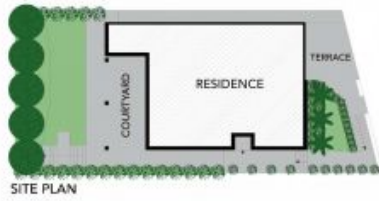
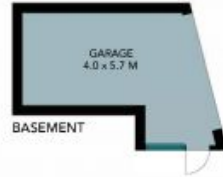

The site plan and floor plan area and volume measurements are indicative and approximate. Builders and users are advised to verify all measurements. Plans should not be relied on. Interested parties should make and rely on their own enquiries. All other information provided has been collected from reliable sources but cannot be guaranteed for accuracy.



235 Sydney Road, Fairlight





FIRST FLOOR



BASEMENT



GROUND FLOOR

The floor plan is not to scale, measurements are indicative and in metres. All features included in this 3D plan are for inspiration purposes only. This is not an exact replica of the property or the position of exterior elements. Plans should not be relied on. Interested parties should make and rely on their own enquiries.



235 Sydney Road, Fairlight

