



45 Boundary Street Roseville, NSW

4

2

2

### Stunning Federation character details with quiet interiors

An exceptionally welcoming home, "Erringha" c.1910 presents rich architectural character complimented by light airy interiors and a private north to rear garden. The layout provides superb adaptability for configuring rooms to individual needs and opportunity to personalise. The location offers a walk to Roseville rail, Chatswood retail and sits within popular Roseville Public School zone.

Price:

Contact Agent



**Jill Henry**

0416 493 555



**Sahil Kotian**

0434 172 588

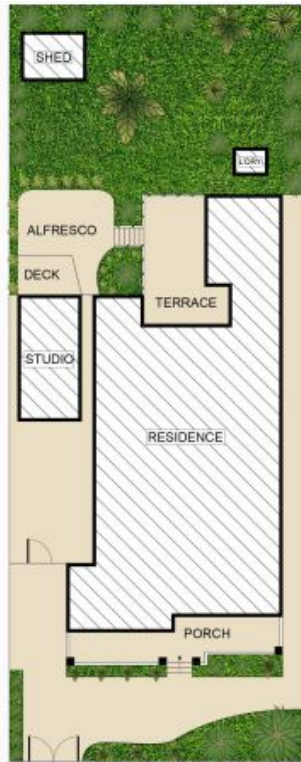

**45 Boundary Street, Roseville**

INTERNAL AREA: 208 SQM APPROX.

DISCLAIMER: 3D Property View accepts no liability for the accuracy of details contained within our floor plans. All plans are drawn and also checked to the best of our ability, however information contained in our floor plans such as area calculations are approximate, and have not been surveyed or drawn to scale. Our floor plans are for representational purposes only and should be used as such. Do not attempt to refer to our floor plans for structural or detailed information.