



Artist impression



The floor plan is for guide purposes only and is not to be used for legal purposes. This is not an exact replica of the property in the position of exterior elements. Plans should not be used as a reference for construction. Please contact the agent for more information.

10 Murphys Avenue, Gwynneville
stonerealestate.com.au

Produced by DMMPT

2/10 Murphys Avenue Gwynneville, NSW



Stylish with convenience

A wonderful opportunity to secure an immaculately designed brand new residence, this property offers two Torrens title duplexes. Each impressive home showcases premium inclusions throughout its cleverly crafted dual level layout. Conveniently located, they are close to Wollongong Botanic Garden, the University of Wollongong, schools and transport.

Price: \$1,130,000



Paul Piacentin

0411 754 884



Matthew Kasbarian

0432 521 051

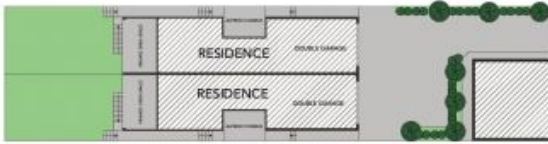

SITE PLAN



FIRST FLOOR



GROUND FLOOR

The site plan and floor plan are not to scale; measurements are indicative and in metres. Bushes and trees are placed for illustration purposes. Plans should not be relied on. Interested parties should make and rely on their own enquiries.



Produced by DIAKRIT

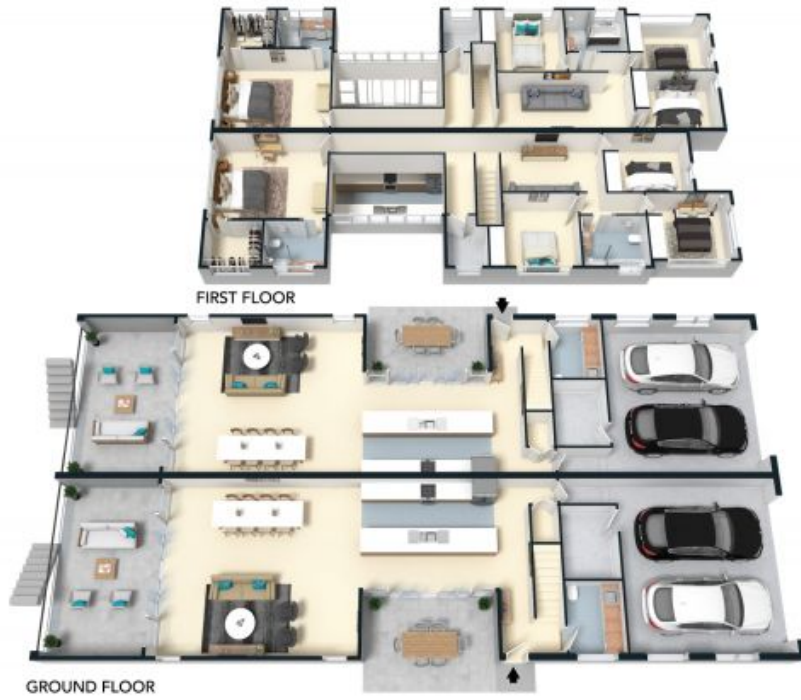

The floor plan is not to scale; measurements are indicative and in metres. All features included in this 3D plan are for inspiration purposes only. This is not an exact replica of the property or the position of exterior elements. Plans should not be relied on. Interested parties should make and rely on their own enquiries.

10 Murphys Avenue, Gwynneville
stonerealestate.com.au

Produced by DIAKRIT