



15 Clydesdale Street Wadalba, NSW

4 2 2

Five year young - perfect for first home or investment

Featuring the combination of a convenient location and family friendly floor plan, this low maintenance brick and tile residence would suit first home buyers and investors. Situated close to all necessary amenities including schools, Westfield Tuggerah, Wyong Hospital, beaches, lakes & M1.

Price: \$620,000
Council Rates: \$1,366.00/year (approx)
Water Rates: \$667.00/year (approx)



Renee Wright

0499 179 460



SITE PLAN



The site plan and floor plan are not to scale, measurements are indicative and in metres. Shades and lines are placed for illustration purposes. Plans should not be relied on. Interested parties should make and rely on their own enquiries. All other information provided has been collected from reliable sources but cannot be guaranteed for accuracy.



15 Clydesdale Street, Wadalba



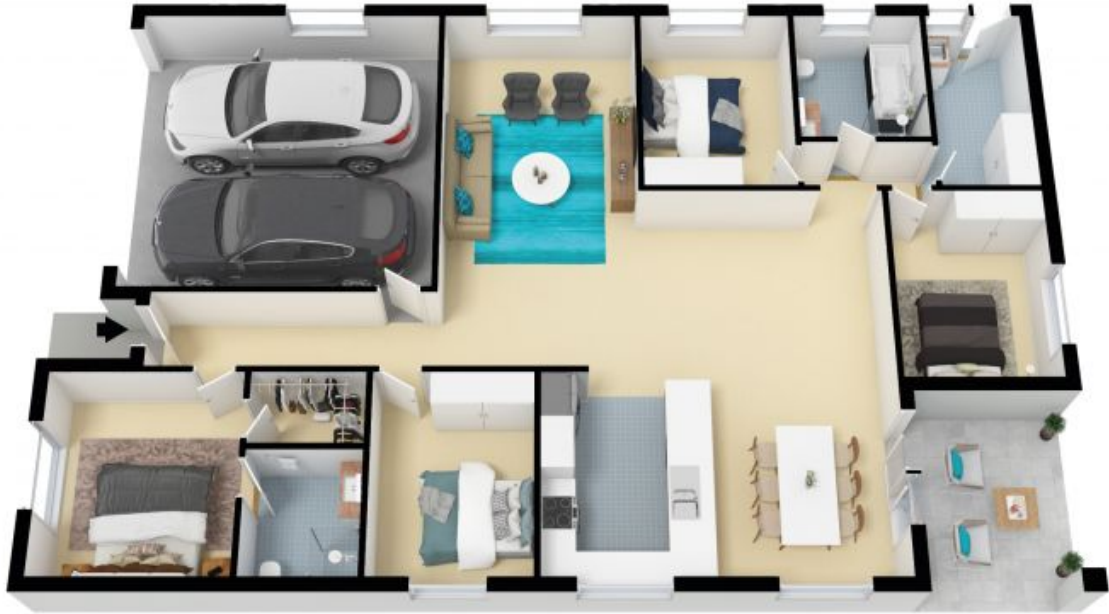

The floor plan is not to scale, measurements are indicative and in metres. All features included in this 3D plan are for inspiration purposes only. This is not an exact replica of the property or the position of exterior elements. Plans should not be relied on. Interested parties should make and rely on their own enquiries.

15 Clydesdale Street, Wadalba

