



6/333 Condamine Street Manly Vale, NSW



Ultra-modern executive pad in key central setting

Defined by its remarkably spacious and versatile layout, sleek and stylish finishes and spectacular entertainers' terrace with district views, this impressive apartment promises a lifestyle of supreme luxury and convenience. Placed on the top floor of a two year old security building with lift access, it is literally footsteps to B-line city buses, supermarkets and cafes and minutes to a selection of beaches.

Price: \$705,000



Eddy Piddington

0414 333 907



Michael Egan

0499 172 009



(NOT IN POSITION)

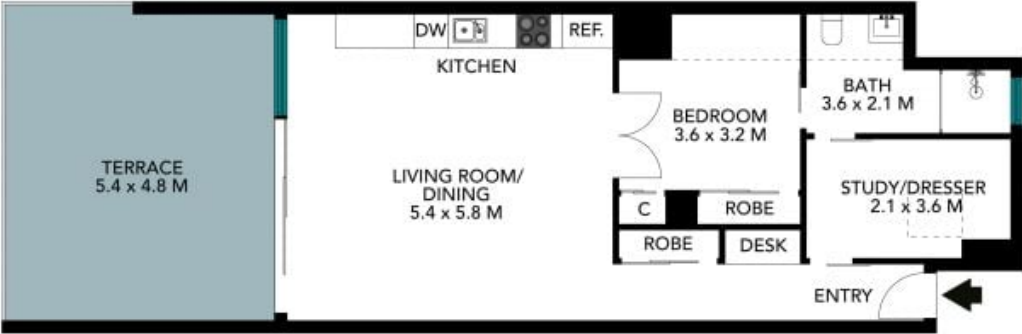

The floor plan is not to scale, measurements are indicative and in metres. Labels for elements are not to position. Plans should not be relied on. Interested parties should make and rely on their own enquiries. All other information provided has been collected from reliable sources but cannot be guaranteed for accuracy.



6/333 Condamine Street, Manly Vale





The floor plan is not to scale, measurements are indicative and in metres. All features included in this 3D plan are for inspiration purposes only. This is not an exact replica of the property or the position of exterior elements. Plans should not be relied on. Interested parties should make and rely on their own enquiries.



6/333 Condamine Street, Manly Vale

