



2/59 Rowland Avenue Wollongong, NSW 3 2 1

Perfect first home or investment opportunity

Located in a convenient pocket close to the Wollongong Public and Private Hospitals, this townhouse offers a great opportunity for either the first home buyer or investor. Open plan living and dining downstairs opens onto a private courtyard area, offering a quiet space to unwind. Set in a quiet complex of only eight, you will love the ability to walk to the Wollongong Train Station, making this low maintenance home suitable for those working in Wollongong or even commuting to Sydney.

Price: \$650,000



Sarah Ward 0400 439 602



William Woods 0411 398 321

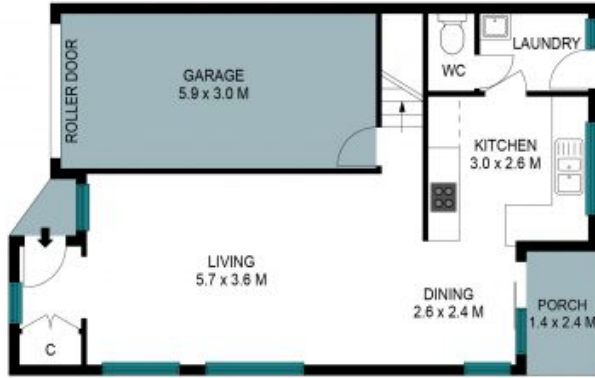

GROUND LEVEL



UPPER LEVEL

The site plan and floor plan are not to scale. Measurements are indicative and in metres. Bushes and trees are placed for illustrative purposes. Plans should not be relied on. Interested parties should make and rely on their own enquiries. All other information provided has been collected from reliable sources but cannot be guaranteed for accuracy.



2/59 Rowland Avenue, Wollongong

