

30a Wattle Street Killara, NSW

5

3

2

Private blue-ribbon estate level north to rear garden

Built c.1938, a grand home of outstanding elegance. Privately positioned on a 1815sqm approx. estate. Showcasing original character, blended with family-friendly updates for versatile living, with gracious entertaining on the sandstone terrace overlooking the pool. Set in Killara's blue-ribbon east side, presenting level park-like grounds with north to rear aspect.

Price:

Contact Agent



Steven Kourdis

0402 555 675



Matt Payne

0435 825 242



FIRST FLOOR



GROUND FLOOR

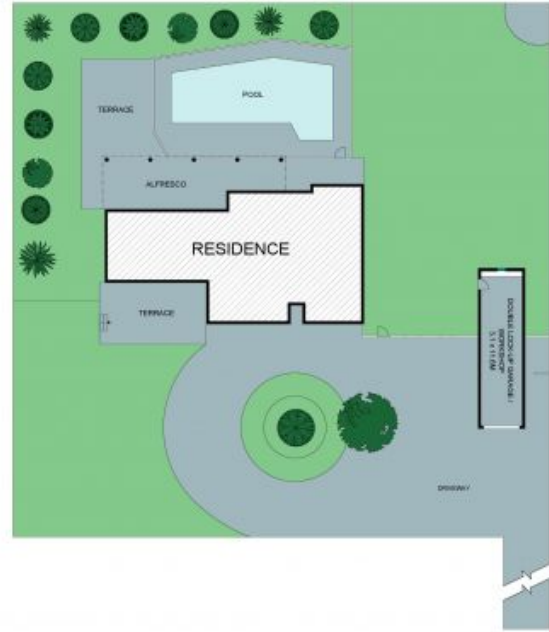

SITEPLAN

The site plan and floor plan are not to scale. Measurements are indicative in meters. Bushes and trees are placed for illustration purposes. Plans should not be relied on. Interested parties should make and rely on their own inquiries. All other information provided has been collected from reliable sources but cannot be guaranteed for accuracy.

30A Wattle Street, Killara





FIRST FLOOR



GROUND FLOOR



The site plan and floor plan are not to scale, measurements are indicative in meters. Bathing and trees are placed for illustration purposes. Plans should not be relied on, interested parties should make and rely on their own inquiries. All other information provided has been collected from reliable sources but cannot be guaranteed for accuracy.

30a Wattle Street, Killara

