



104/39-45 George Street Rockdale, NSW



Modern spacious unit in village hub

Make a superb debut onto the property market, or a winning investment, with this contemporary home. On the elevated first floor of a quality development, the property fuses expansive open-plan living with alfresco space. Walk to cafes, grocers and fast trains from this quiet and charming village setting, and live just 2km from Lady Robinson's Beach, within 15km of the CBD.

Price: \$667,000



George Kambouroglou

0422 421 111



Sam Abbas

0406 750 075



The floor plan is not to scale, measurements are indicative and in metres. Colour statements are not to position. Plans should not be relied on. Interested parties should make and rely on their own enquiries. All other information provided has been collected from reliable sources but cannot be guaranteed for accuracy.

104/39 George Street, Rockdale



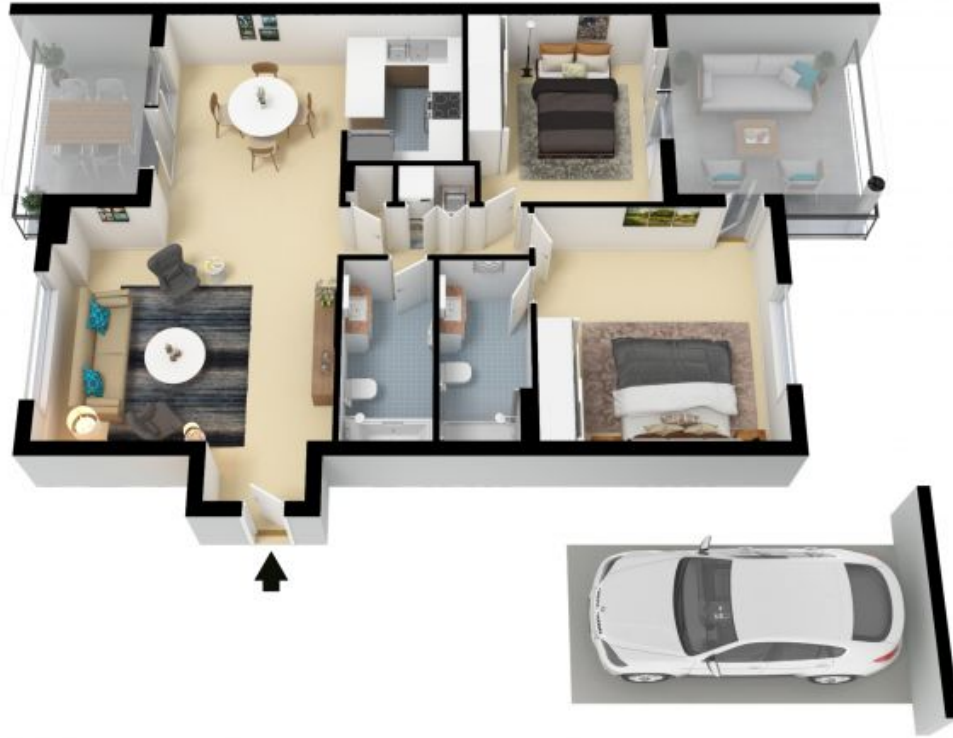

The floor plan is not to scale, measurements are indicative and in metres. All features included in this 3D plan are for inspiration purposes only. This is not an exact replica of the property or the position of exterior elements. Plans should not be relied on. Interested parties should make and rely on their own enquiries.

104/39 George Street, Rockdale

