



10 Careebong Road Frenchs Forest, NSW

3

2

2

Charming family home in sought-after setting

Positioned on a huge 734sqm near-level block backing onto a leafy reserve in a quiet residential street, this much-loved weatherboard home offers a wonderful lifestyle opportunity in a popular, family-friendly neighbourhood. Freshly painted, with a gorgeous new designer kitchen and ripe with potential to renovate and add further value, it's ready for new owners to move in and make it their own.

Price:

Contact Agent



Louise Ashdown

0414 764 108



Louise Ashdown

0414 764 108

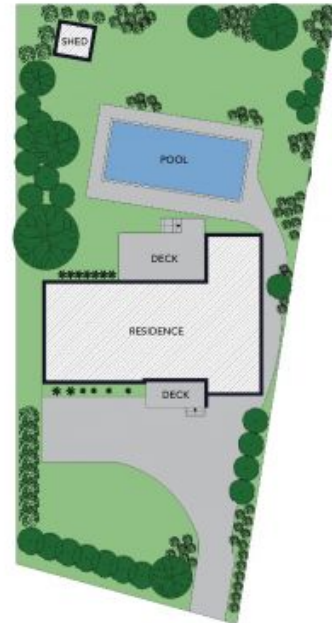

SITE PLAN



The site plan and floor plan are not to scale, measurements are indicative and in metres. Shades and lines are placed for illustration purposes. Plans should not be relied on. Interested parties should make and rely on their own enquiries. All other information provided has been collected from reliable sources but cannot be guaranteed for accuracy.

10 Careebong Road, Frenchs Forest





The floor plan is not to scale, measurements are indicative and in metres. All features included in this 3D plan are for inspiration purposes only. This is not an exact replica of the property or the position of water elements. Plans should not be relied on. Interested parties should make and rely on their own enquiries.



10 Careebong Road, Frenchs Forest

