



18 Bligh Crescent Seaforth, NSW



One spectacular block; two luxury homes

Boasting a prestigious dress circle setting in an exclusive harbourfront cul-de-sac, and positioned on a huge 1,025sqm block with never-to-be-built-out Middle Harbour and city skyline views from all levels, this incredible property offers the rare opportunity to secure two luxury homes on one spectacular block. Taking full advantage of the stunning harbourside setting, luxe living spaces are oriented towards yacht sprinkled Powder Hulk Bay with the impressive brand-new secondary dwelling presenting a raft of opportunities, including dual family living or rental income.

Price: SOLD
Council Rates: \$711.00 p/q
Water Rates: \$177.00 p/q



Maria Cassarino

0411 818 093



Julian Rowe

0412 544 448

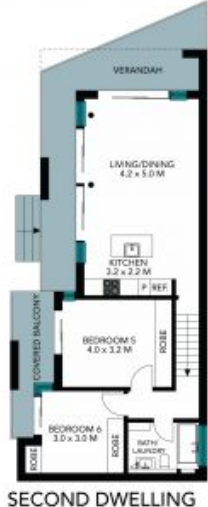

The site plan and floor plans are not to scale, measurements are indicative and in meters. Bathes and totes are placed for illustration purposes. Plans should not be relied on. Interested parties should make and rely on their own enquiries. All other information provided has been collected from reliable sources but cannot be guaranteed for accuracy.

18 Bligh Crescent, Seaforth





GROUND FLOOR

TOP FLOOR
(ENTRY LEVEL)

SECOND DWELLING

The floor plan is not to scale, measurements are indicative and in metres. All features included in this 3D plan are for inspiration purposes only. This is not an exact replica of the property or the position of exterior elements. Plans should not be relied on. Interested parties should make and rely on their own enquiries.

18 Bligh Crescent, Seaforth

STONE