

6 Carmen Close Copacabana, NSW



Entertainer's retreat

Showcasing a smart and distinctive style with a wonderful indoor/outdoor flow, this versatile home is ideal for the young family or couple who enjoy entertaining. With living options across two levels, plus spacious backyard and fantastic front deck area with outdoor spa.

At the heart of the home is the impressive family kitchen, which opens up to the front deck and features a Belling dual fuel cooker and island bench, while to kick back and relax you have a comfortable living room with peaceful leafy outlook and wide combustion fireplace. Idyllic location at the end of a quiet cul de sac.

Price: Another sold at Auction!
Council Rates: \$358.69 p/q
Water Rates: \$174.84 p/q



Andrew Thomson

0405 103 077

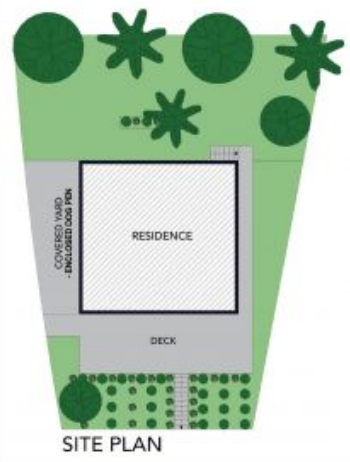
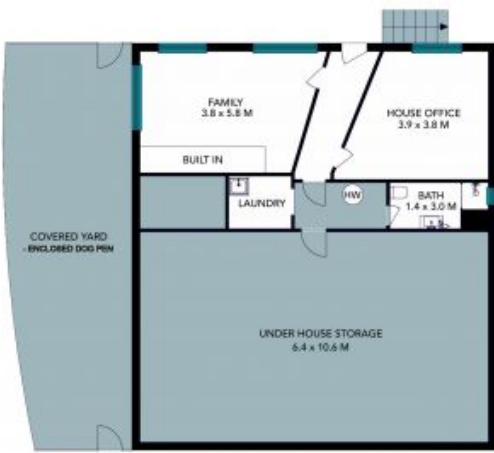

The site plan and floor plan are not to scale; measurements are indicative and in metres. Bathrooms are placed for illustration purposes. Plans should not be relied on. Interested parties should make and rely on their own enquiries. All other information provided has been collected from visible sources but cannot be guaranteed for accuracy.



6 Carmen Close, Copacabana

