



12 The Crest Killara, NSW

4 

2 

2 

Sold Off Market

Defined by its stunning manicured gardens, stylish interiors and superb alfresco entertaining drenched in northern sunshine, this beautifully renovated home offers an outstanding lifestyle opportunity. Set on an elevated 846 sqm approx. parcel in a blue-ribbon address in Killara's sought-after east-side, the full-brick home enjoys a conveniently central location just a stroll to Killara Park, transport, shops and school.

Price:

Contact Agent



Ryan Woo

0410 884 680



Matt Payne

0435 825 242



UPPER FLOOR

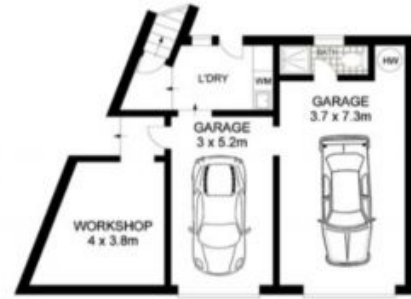

LOWER FLOOR

The floor plan is not to scale, measurements are indicative and in metres. Exterior elements are not in position. Plans should not be relied on. Interested parties should make and rely on their own enquiries. All other information provided has been collected from reliable sources but cannot be guaranteed for accuracy.

12 The Crest, Killara

