



6 Romford Road Epping, NSW



Solid Original Full Brick Residence 1.2kms easy walk to Epping station

SOLD BY JAMES KWON 0414 9888 91

Sold in after 7 days on the market, prior to auction

81 Groups

20 Contract

This original solid full brick home is set on a generous 835 sqm parcel within 1.2kms walking distance to Epping station. It is positioned in one of Epping's desired location within the Epping Heights Public School, Cheltenham Girls & Epping Boys High school catchment area. Solid full brick construction in need of TLC. Perfect for renovators, potential to build up, extend, add granny flat or possibly to rebuild a dream home (STCA). Locations!!

Price:

\$2,000,000



James Kwon

0414 988 891

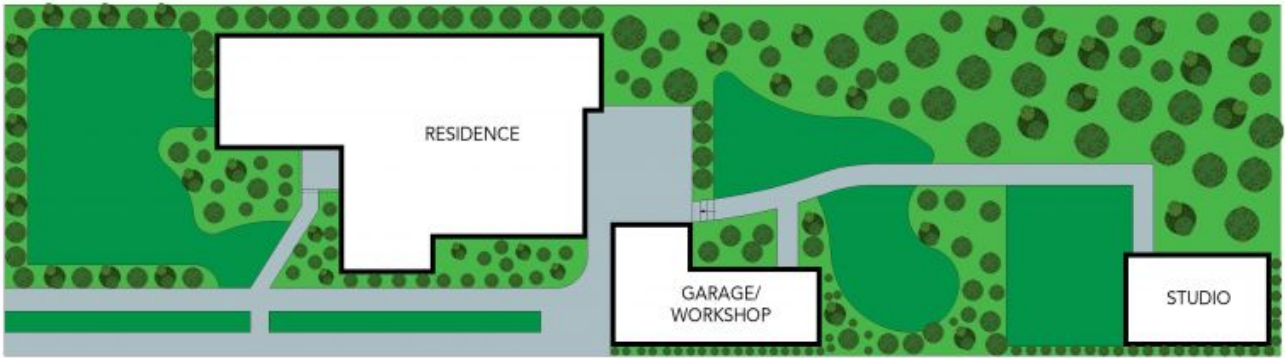

SITE PLAN



The floor plan is not to scale; measurements are indicative and in metres. Exterior elements are not in position. Plans should not be relied on. Interested parties should make and rely on their own enquiries.



6 Romford Road, Epping

