

5/4 Monomeeth Street Bexley, NSW

2 

1 

Tidy budget-pleasing pad a walk from station

Rockdale Station is a stroll away, along with shops, schools and cafes, ensuring this tidy apartment meets all the requirements for convenient and comfortable living. With polished floorboards throughout, and its original kitchen and bathroom, the home is perfectly comfortable as-is, with scope for future improvement. Step onto the property ladder or secure a solid investment.

- Two bedrooms, main with built-in wardrobe.
- Original kitchen in good condition offers convenient breakfast bar.
- Open-plan lounge and dining with warm and inviting original floorboards.
- Original bathroom and linen cupboard.
- Shared laundry facilities conveniently placed right out your door.
- Solid-walk up red brick block, boutique sized with just two levels.
- 950 metres from Rockdale Station, offering easy commute.
- Quiet street, a stroll to cafes and shops, short drive to the beach.



Sam Abbas

0406 750 075



Bill Kostov

0432 617 769

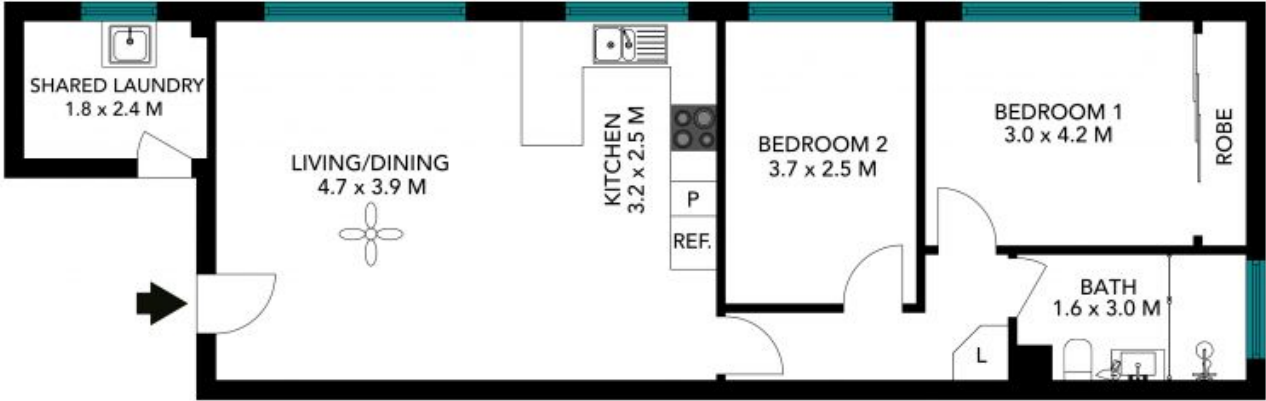

The floor plan is not to scale, measurements are indicative and in metres. Color elements are not to position. Plans should not be relied on, interested parties should make and rely on their own enquiries. All other information provided has been collected from reliable sources but cannot be guaranteed for accuracy.



5/4 Monomeeth Street, Bexley





The floor plan is not to scale, measurements are indicative and in metres. All features included in this 3D plan are for inspiration purposes only. This is not an exact replica of the property or the position of exterior elements. Plans should not be relied on. Interested parties should make and rely on their own enquiries.

5/4 Monomeeth Street, Bexley

