



19/3-5 Copeland Road Beecroft, NSW

3 2 1

Wilberforce Cottage c1838 with modern updates in over 55's development

An elegant fusion of local history seamlessly blended with contemporary living, this prized residence was crafted from bricks from the original cottage on the site - c1838, believed to be the oldest dwelling in Hornsby shire. Retaining the original fireplace in the formal lounge, the home has had an impressive extension and sympathetic renovation to meet demands of modern comforts from discerning buyers.

Price: SOLD
Council Rates: \$354.20 p/q
Water Rates: \$144.11 p/q
Strata Rates: \$1,196.00 p/q



Graham Black

0400 381 217



Kevin Dearlove

0403 338 302

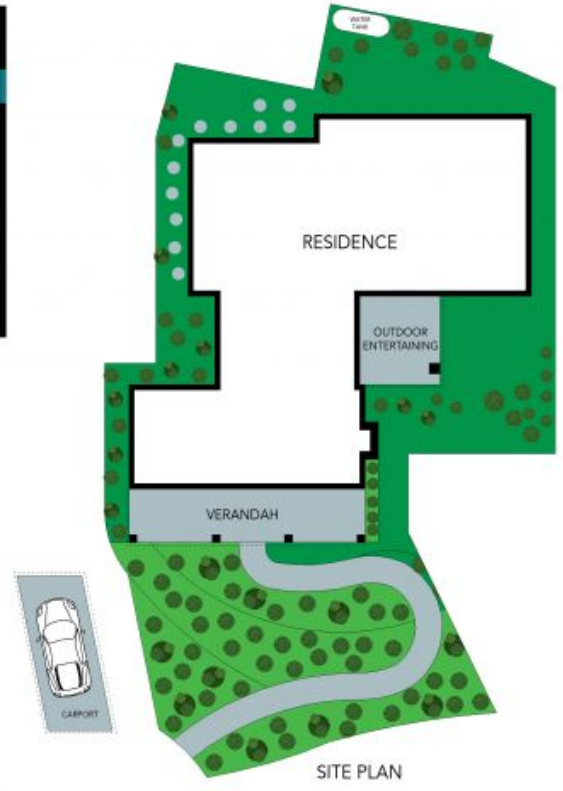

The floor plan is not to scale; measurements are indicative and in metres. Exterior elements are not in position. Plans should not be relied on. Interested parties should make and rely on their own enquiries.



19/3-5 Copeland Road, Beecroft

