



A9 Manning Road Killara, NSW



Sundrenched privacy with expansive flowing layout

A statement of excellence, privately nestled on 1720sqm approx. of sundrenched level north to rear land, this light-filled modern family home presents an impeccably designed flowing layout delivering expansive proportions, impressive quality and outstanding comfort. Located with easy access to Chatswood and North Ryde and within prime school zones.

Price:

Contact Agent



Steven Kourdis

0402 555 675



Jill Henry

0416 493 555



SITE PLAN



1ST LEVEL



GROUND LEVEL



GREEN HOUSE

INTERNAL AREA 404 SQM
EXTERNAL AREA 48 SQM
TOTAL AREA 452 SQM

The site plan and floor plan are not to scale, measurements are indicative and in metres. Balbs and trees are placed for illustrative purposes. Plans should not be relied on. Interested parties should make and rely on their own enquiries. All other information provided has been collected from reliable sources but cannot be guaranteed for accuracy.

A9 Manning Road, Killara





1ST LEVEL



GROUND LEVEL

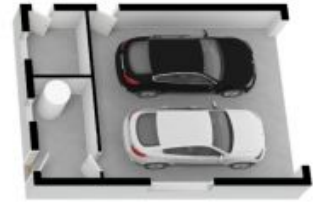

The floor plan is not to scale, measurements are indicative and in metres. All features included in this 3D plan are for inspiration purposes only. This is not an exact replica of the property or the position of exterior elements. Plans should not be relied on. Interested parties should make and rely on their own enquiries.



A9 Manning Road, Killara

