



1/19 Nott Street Warners Bay, NSW

3

2

2

VIVE ? Where lifestyle excellence and design unite

A true statement piece of sheer luxury and designer flair, this high-end development architecturally designed by the award-winning team at SHAC, offers residents an opportunity currently unmatched in Warners Bay. Each home is designed to provide a luxurious oasis for those who demand unparalleled style and quality while enjoying all the benefits of a connected lakeside lifestyle with thriving cafes, waterfront pathways and essentials a walk away.

Price:

Contact Agent

Stone Real Estate -

Head Office

Townhouse 04

3  2.5  2 

SPACE	AREA
Internal	152 m ²
Ground Floor	65 m ²
First Floor	67 m ²
Garage	20 m ²
External	87 m ²
Deck	14 m ²
Yard (incl driveway & paths)	73 m ²
TOTAL	239 m ²

SITE PLAN

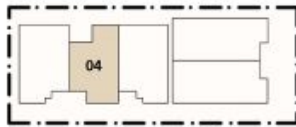

DISCLAIMER

Furniture not included in the contract. Final layout is subject to detailed input from service consultants and authorities. Gross areas are measured to exterior face wall. Refer to strata plan for total areas. Landscaping is indicative only. Refer to landscape plan for details.



Ground Floor



First Floor